

TEAM ASSOCIATED



1:10 SCALE GAS OFF ROAD BUGGY



KIT INSTRUCTION MANUAL

Due to ongoing research and development, photos may not match current kit components. RC10 photos shown equipped with items that may NOT be included with vehicle.

:: Introduction

Thank you for purchasing this Team Associated product. This assembly manual contains instructions and tips for building and maintaining your new Kit. Please take a moment to read through this manual to help familiarize yourself with these steps.

We are continually changing and improving our designs; therefore, actual parts may appear slightly different than in the illustrations. New parts will be noted on supplementary sheets located in the appropriate parts bags.

Check each bag for these sheets before you start to build.

:: KIT Features

RC10GB (Gas Buggy) Features:

- Exclusive Gold Aircraft aluminum tub chassis
- Updated gearing for 2wd Buggy
- Wide buggy front Arms
- Wide Front Axles
- Wider Rear CVA Axles and Axle Spacers
- Wider footprint for performance
- New Rear Shock Tower
- 89 Stealth Car Wing Mounts
- Protech Clear Body with Gas Cutout template
- Stealth ATC Transmission
- Powerful rear disk brakes
- Adjustable Slipper clutch
- 2-second, quick fill fuel tank with filter
- Heavy-duty front and rear buggy arms
- Reversible bellcrank / servo-saver steering
- Vintage Ribbed front tires
- Vintage Spike rear tires
- Gold Anodized, Oil filled shocks
- Ball Differential
- Precision Bearings throughout
- Original release natural white plastic parts
- Adjustable Turnbuckles for camber and toe
- Aluminum Engine Manifold (Non pull start)
- Polished Exhaust pipe (Non Pull Start)
- 2 Shoe Clutch system and flywheel (non pull start)

:: Additional

Your new RC10GB Kit comes as a kit. There are some items you will need to complete your kit (refer to website for suggestions):

- RC two channel surface frequency radio system
- .12 non-pull start engine
- Steering servo
- Starter box
- Receiver battery pack
- Battery charger compliant to battery type
- Polycarbonate specific paint
- Nitro fuel
- Throttle servo
- Starter box battery
- Thread Lock (AE #1596)

Tools included:

- Allen wrenches
(.035", .050", 1/16", 3/32")
- Shock building tool

:: Other Helpful Items

- Silicone Shock Fluid (Refer to website for complete listings)
- Tire Adhesive (AE #1697)
- Shock Pliers (AE #1681)
- Wire Cutters / Hobby Knife
- FT 7-Piece 1/4 in Hex Driver Set (AE #1650)
- Body Scissors (AE #1737)
- Green Slime shock lube (AE #1105)
- Needle Nose Pliers
- Reamer / Hole Punch (AE #1499)
- Calipers or a Precision Ruler
- Soldering Iron

Associated Electrics, Inc.
21062 Bake Parkway
Lake Forest, CA 92630



Customer Service
Tel: 949.544.7500
Fax: 949.544.7501

:: Hardware - 1:1 Scale View

Cap Head (shcs)

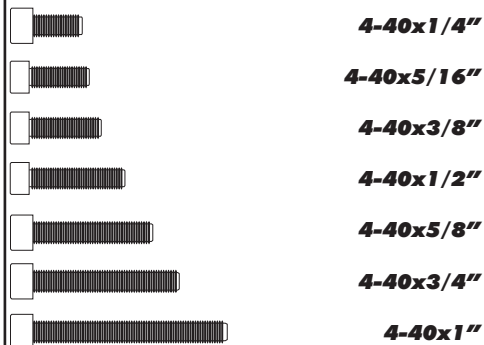

Bearings / Bushings

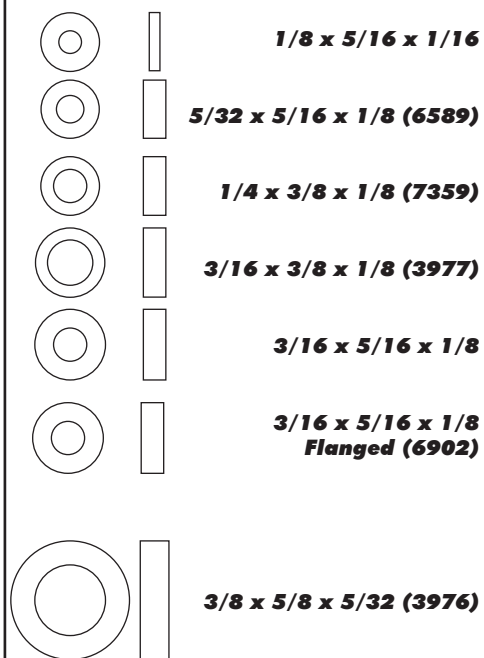

Flat Head (fhcs)

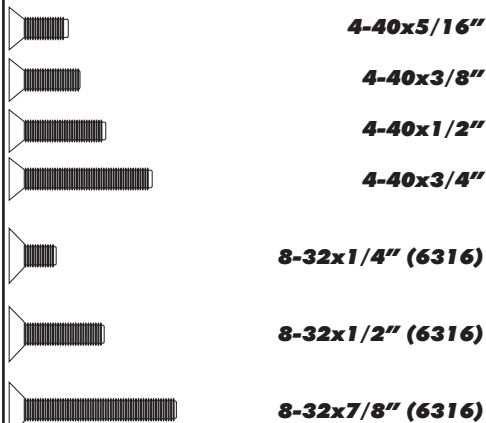

Set Screws



Nuts (lock/plain)

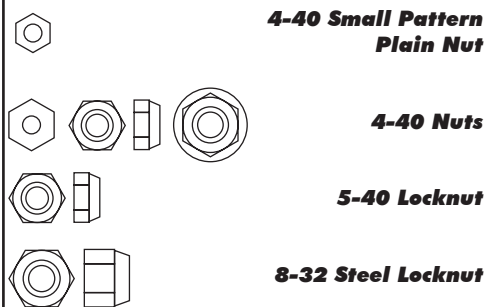

Clips

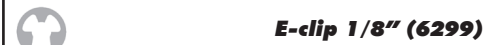

Button Head (bhcs)



Diff Balls

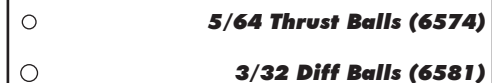

Shims and Washers

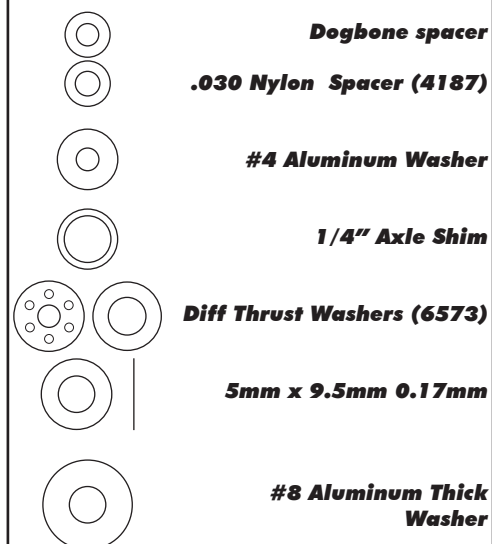

Notes:

:: Table of Contents

1..... Cover	16..... Fuel Tank / Servo Build (Bag H, F)
2..... Introduction	17 Engine / Exhaust Install (Bag I)
3..... 1:1 Hardware "Fold Out"	18..... Throttle and Branke Links Build (Bag J)
4..... Table of Contents	20..... Fuel Tubing Install (Bag Misc)
5..... Nose Plate / Bell Cranks Build (Bag A)	20..... Air Fulter Install (Bag Misc)
6..... Front Suspension Build (Bag B)	20..... Receiver Battery Pack Install (Bag D, I, Misc)
7..... Transmission Build (Bag C)	21..... Antenna, Receiver, Body Install (Bag Misc)
9..... Rear End Build (Bag D)	22..... Back Cover
11..... Shocks Build (Bag E)	
13..... Turnbuckles Build (Bag F)	
15..... Wheels / Tires Build (Bag G)	

:: Notes

This symbols indicates a special note or instruction in the manual.



There is a 1:1 hardware foldout page in the front of the manual. To check the size of a part, line up your hardare with the correct drawing until you find the exact size.

Associated Electrics, Inc.
21062 Bake Parkway
Lake Forest, CA 92630



Customer Service
Tel: 949.544.7500
Fax: 949.544.7501

:: Nose Plate / Bell Cranks Build - Bag A - Step 1

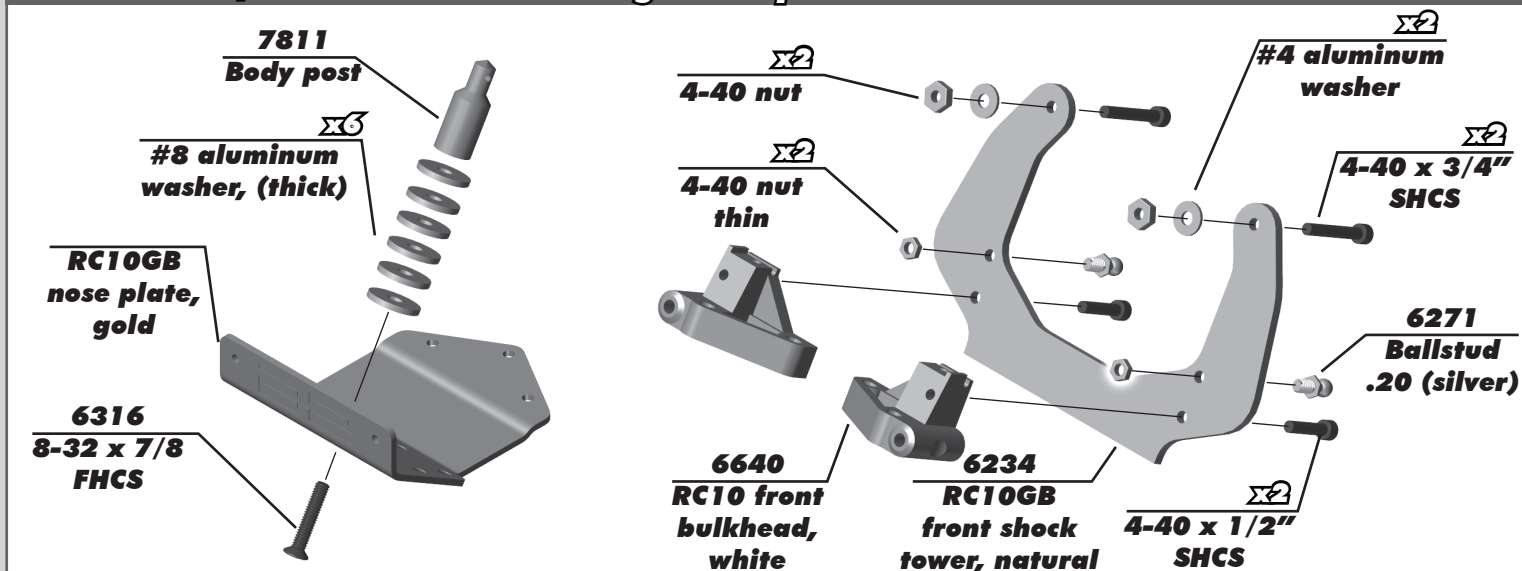

:: Nose Plate / Bell Cranks Build - Bag A - Step 2

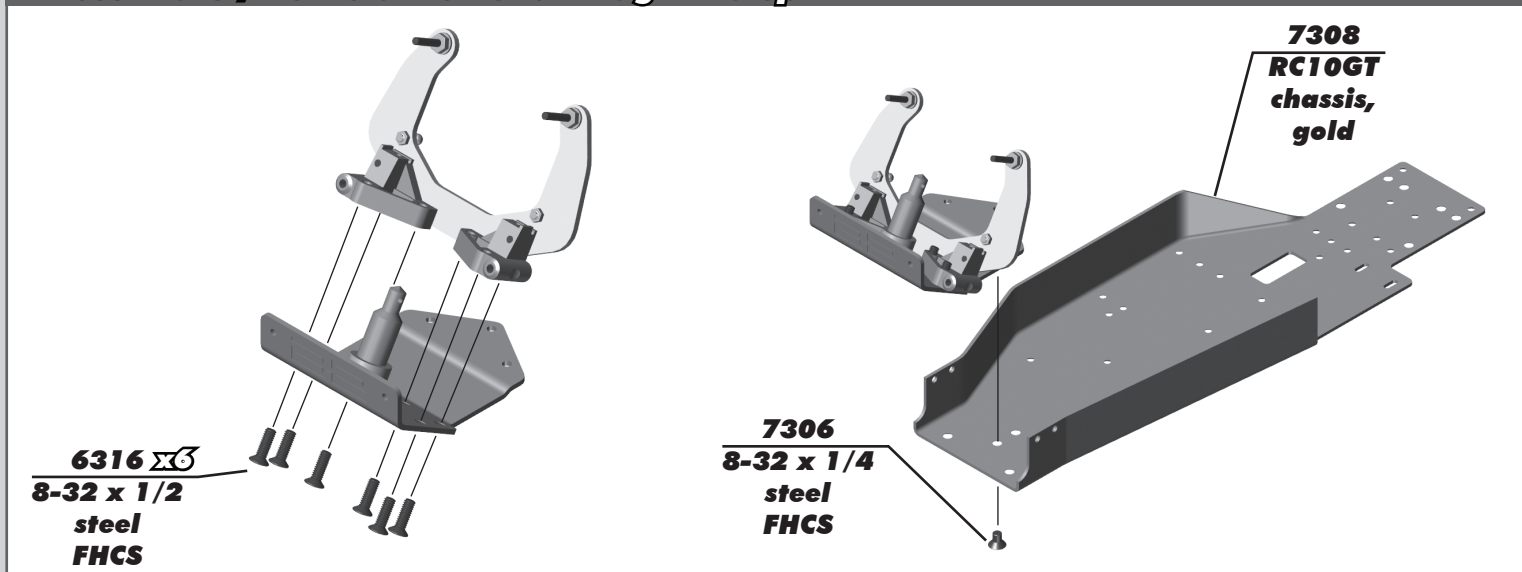

:: Nose Plate / Bell Cranks Build - Bag A - Step 3

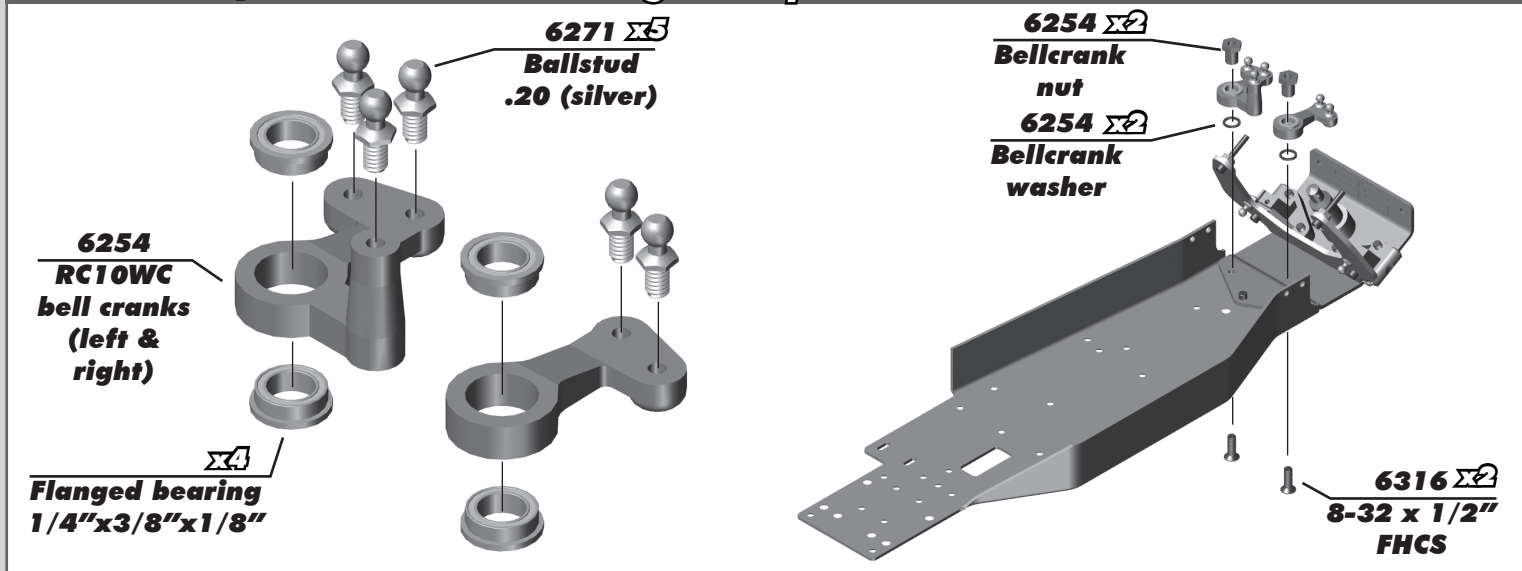

:: Nose Plate / Bell Cranks Build - Bag A - Step 4

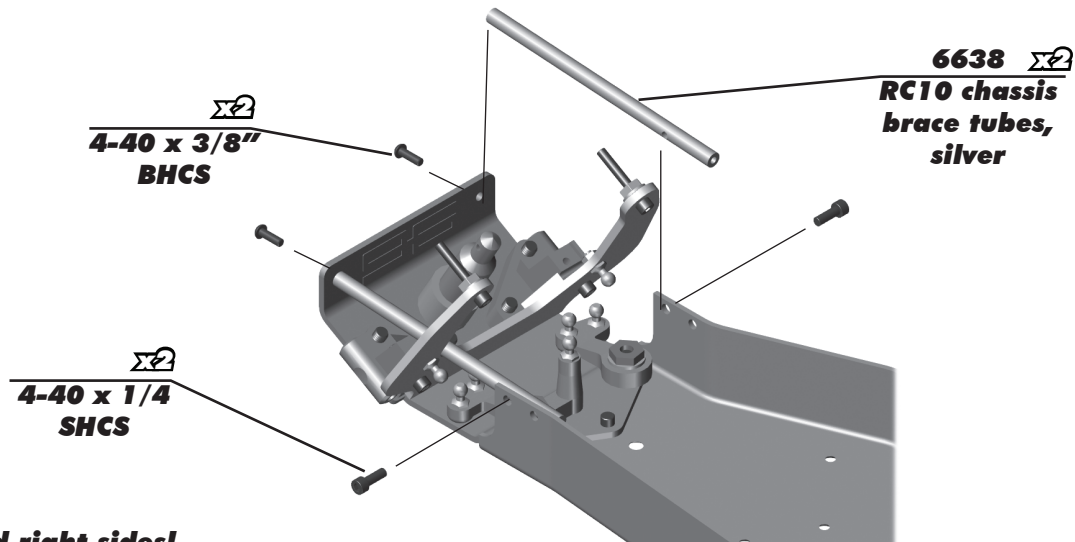

Build left and right sides!

:: Front Suspension Build - Bag B - Step 1

LEFT

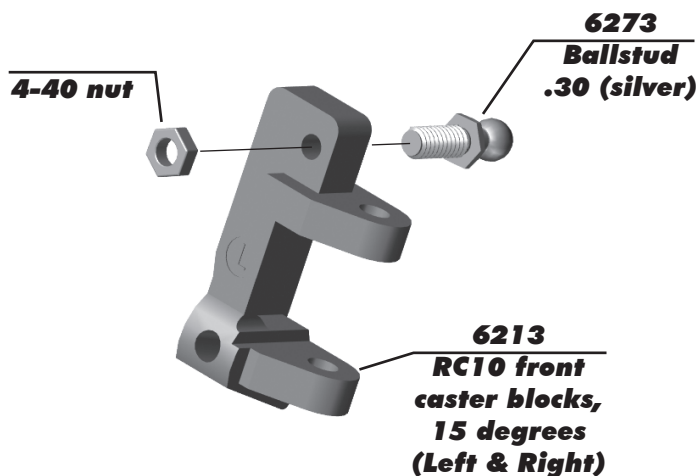

Build left and right sides!

LEFT

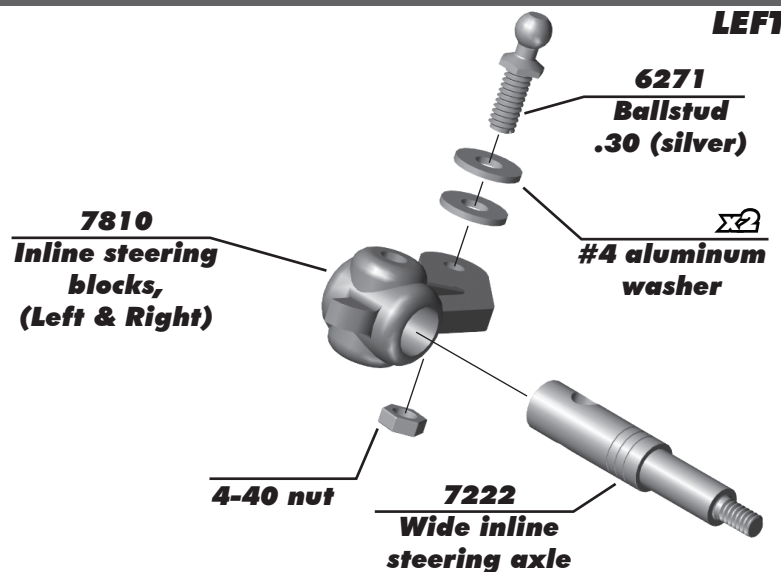

:: Front Suspension Build - Bag B - Step 2

LEFT

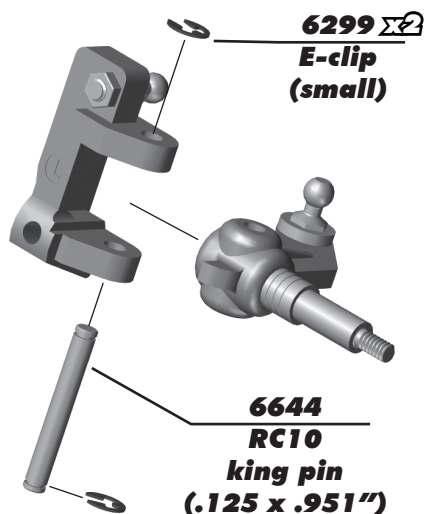

Build left and right sides!

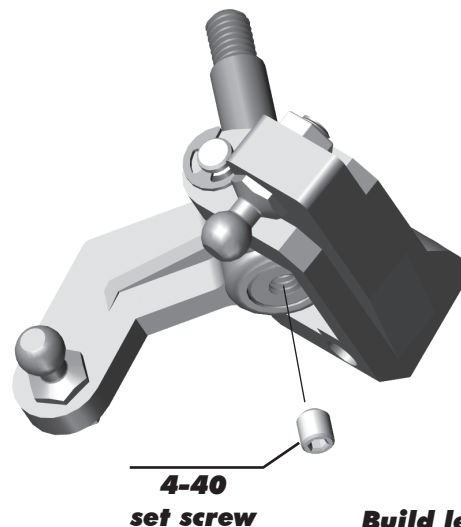

Build left and right sides!

:: Front Suspension Build - Bag B - Step 3

LEFT

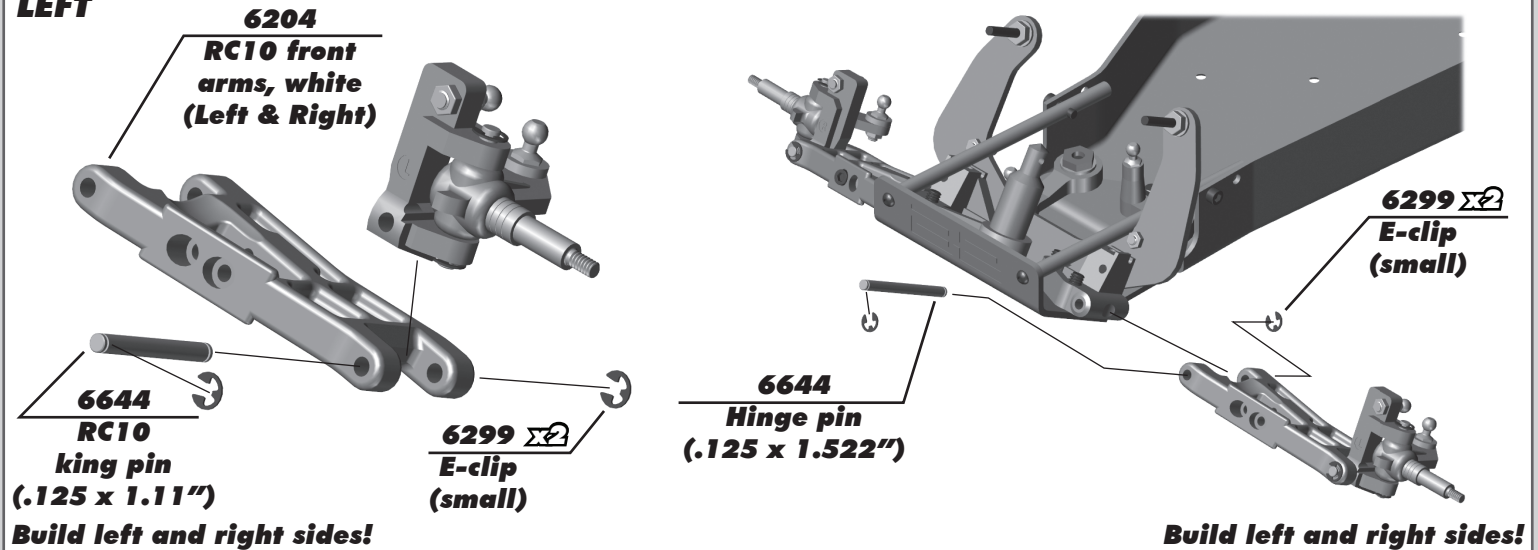

:: Transmission Build - Bag C - Step 1

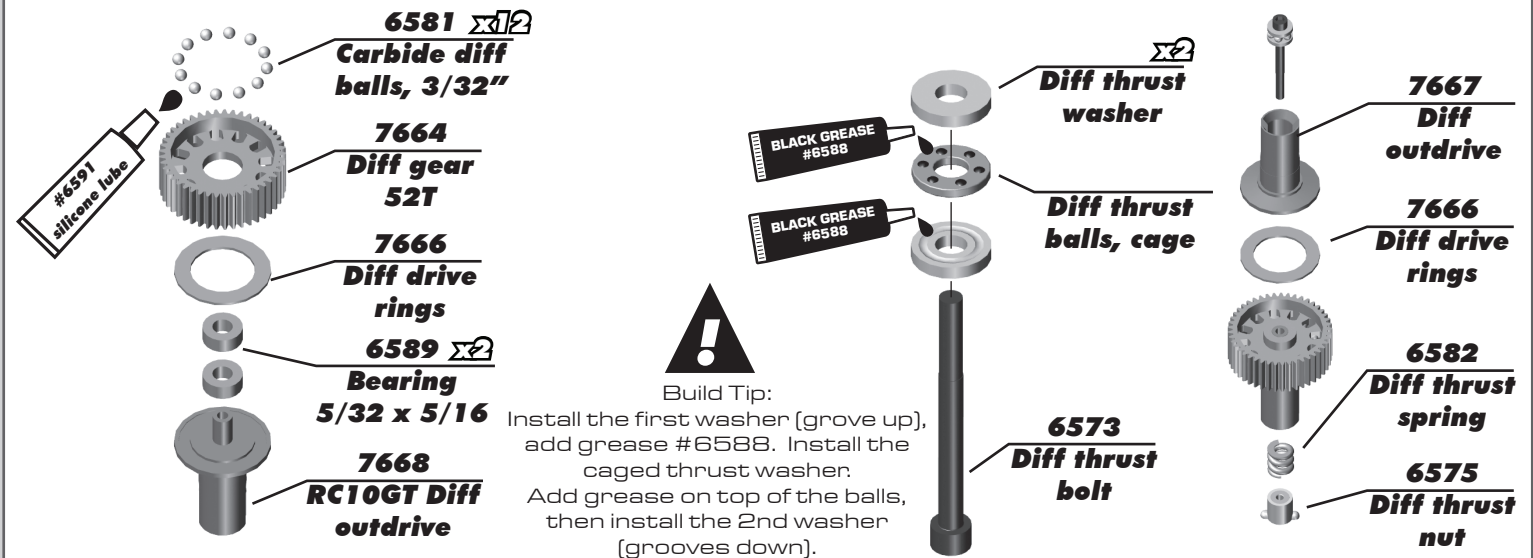

:: Transmission Build - Bag C - Step 2

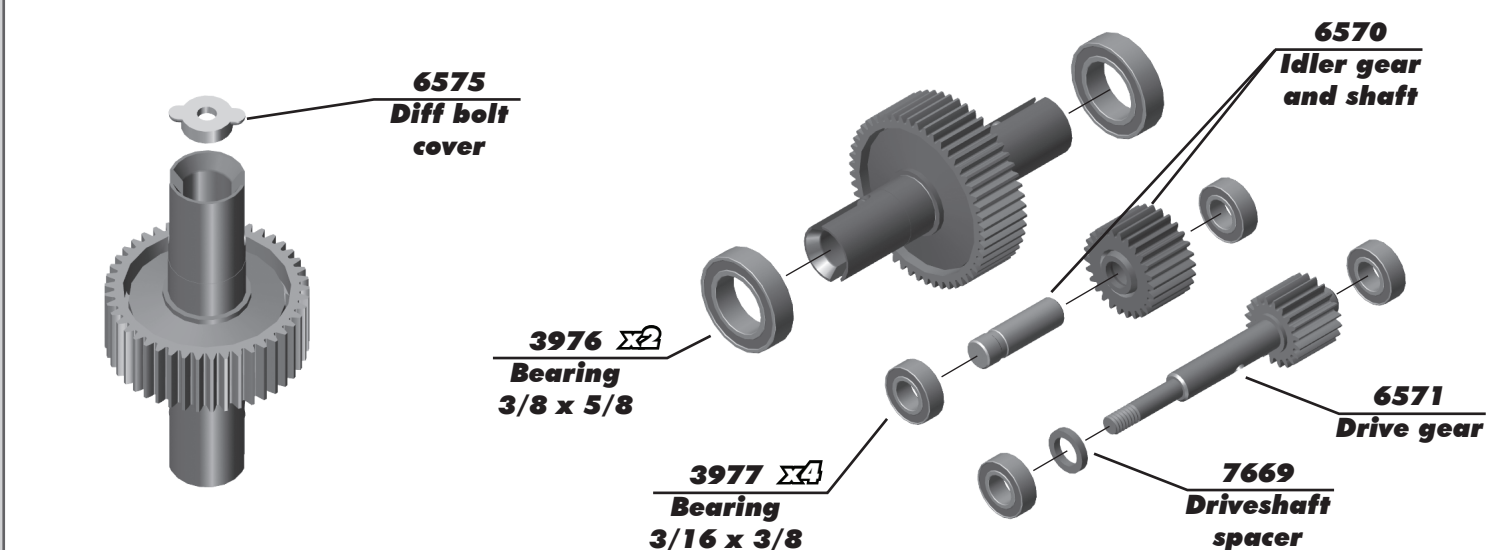

:: Transmission Build - Bag C - Step 3

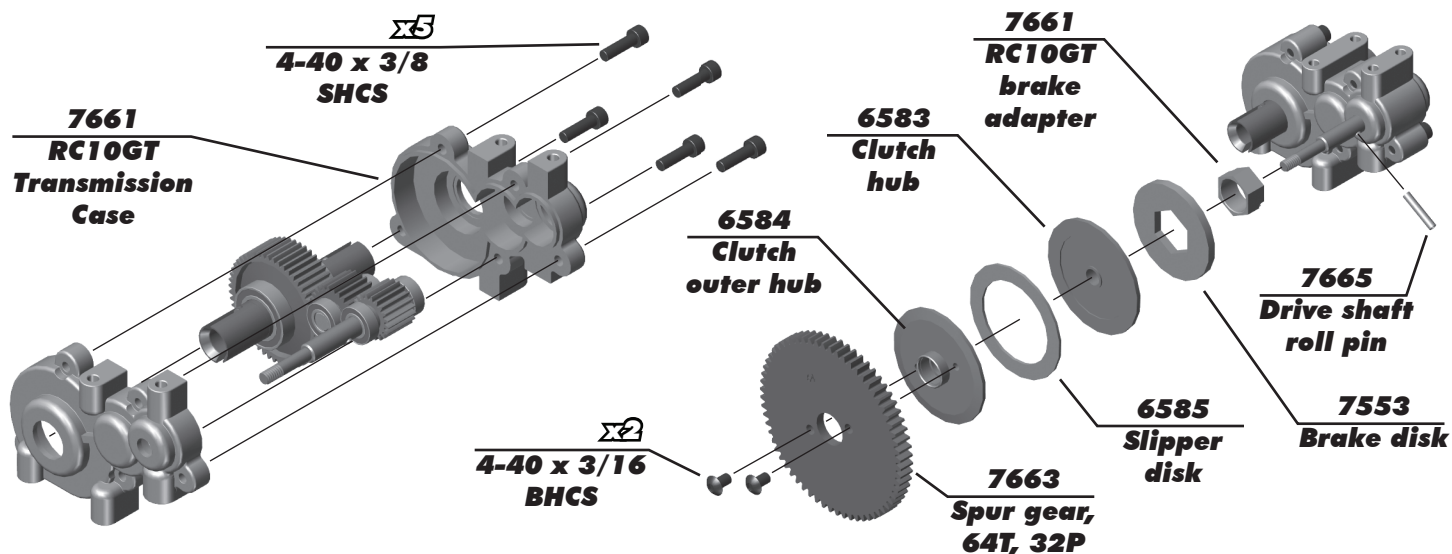

:: Transmission Build - Bag C - Step 4

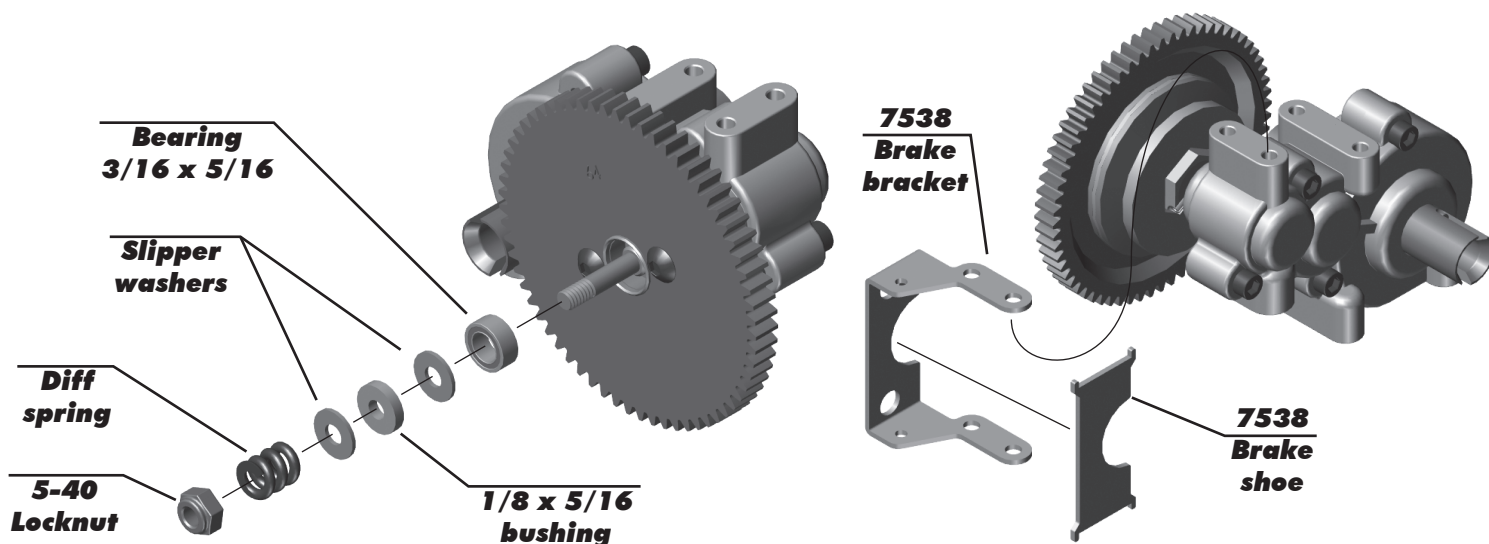

:: Transmission Build - Bag C - Step 5

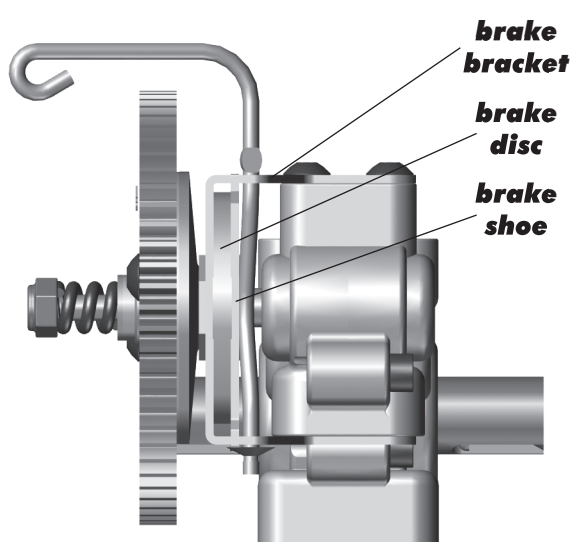

! INSTALL BRAKE BRACKET

1) Slide the bracket assembly onto the transmission. Make sure the brake disc is centered between the bracket and brake shoe as shown.

2) Secure the bracket to the transmission as shown, using two 4-40 x 5/16 BHCS screws in the top holes of the brake bracket.

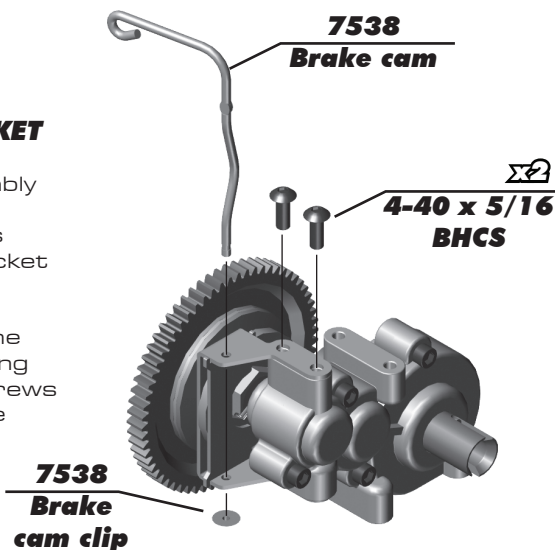

:: Rear End Build - Bag D - Step 1

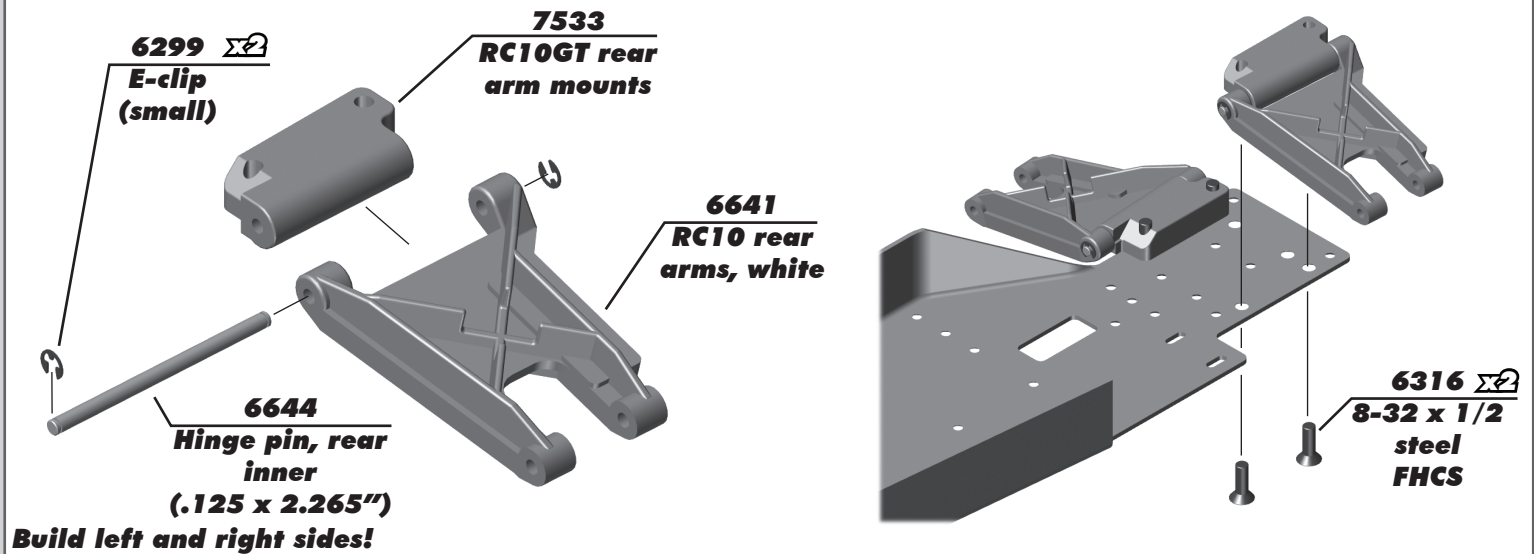

:: Rear End Build - Bag D - Step 2

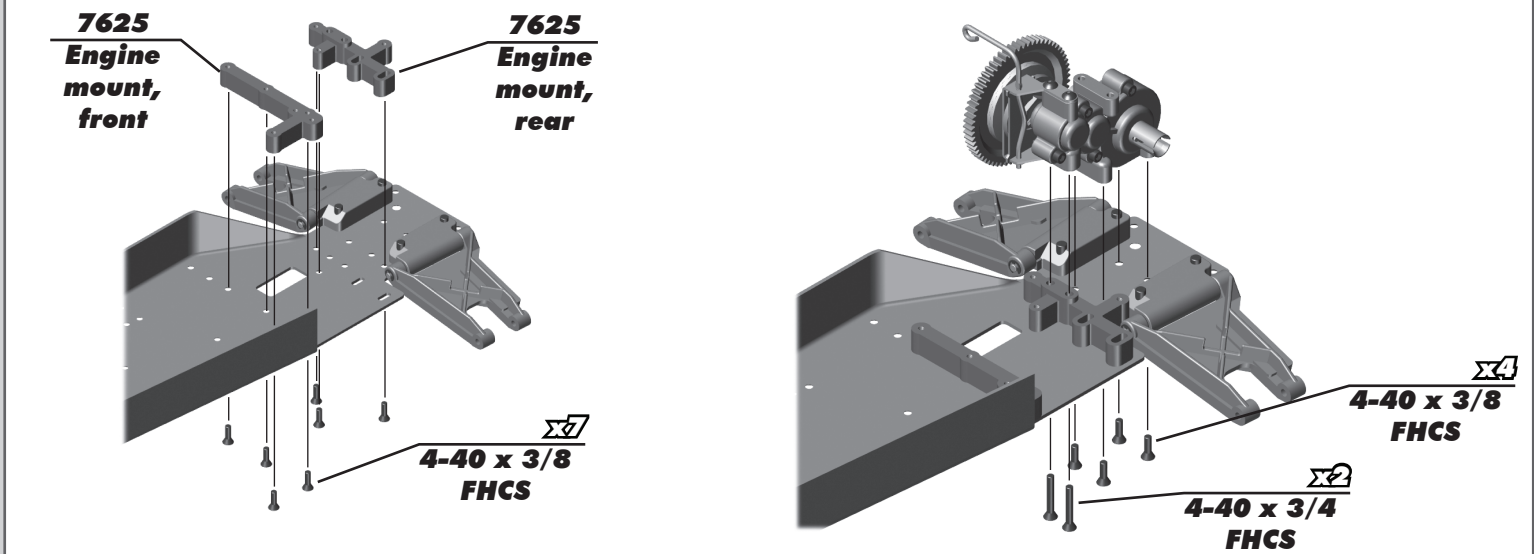

:: Rear End Build - Bag D - Step 3

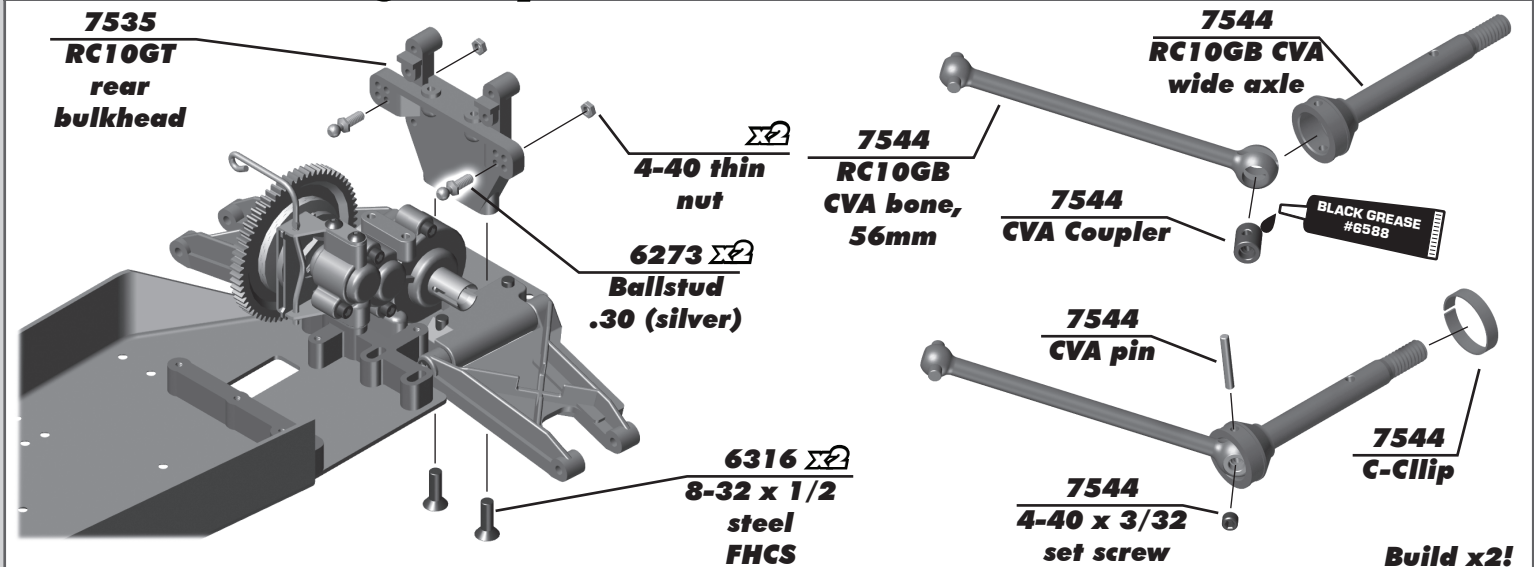

:: Rear End Build - Bag D - Step 4

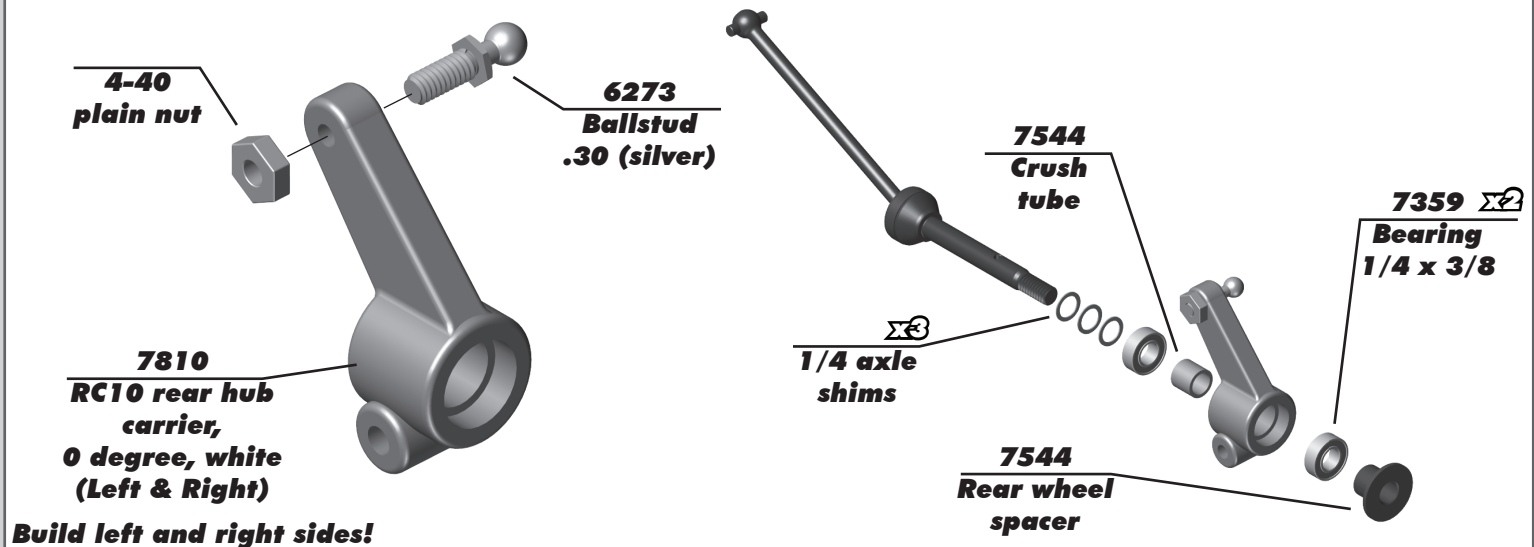

:: Rear End Build - Bag D - Step 5

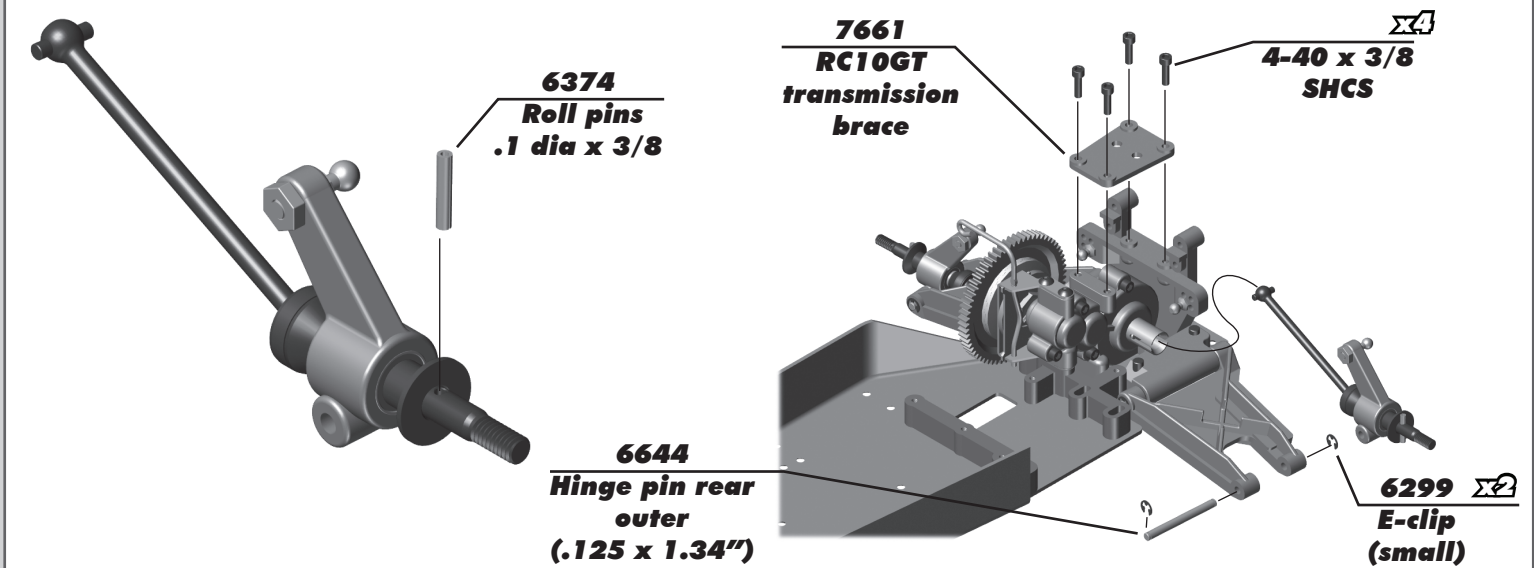

:: Rear End Build - Bag D - Step 6

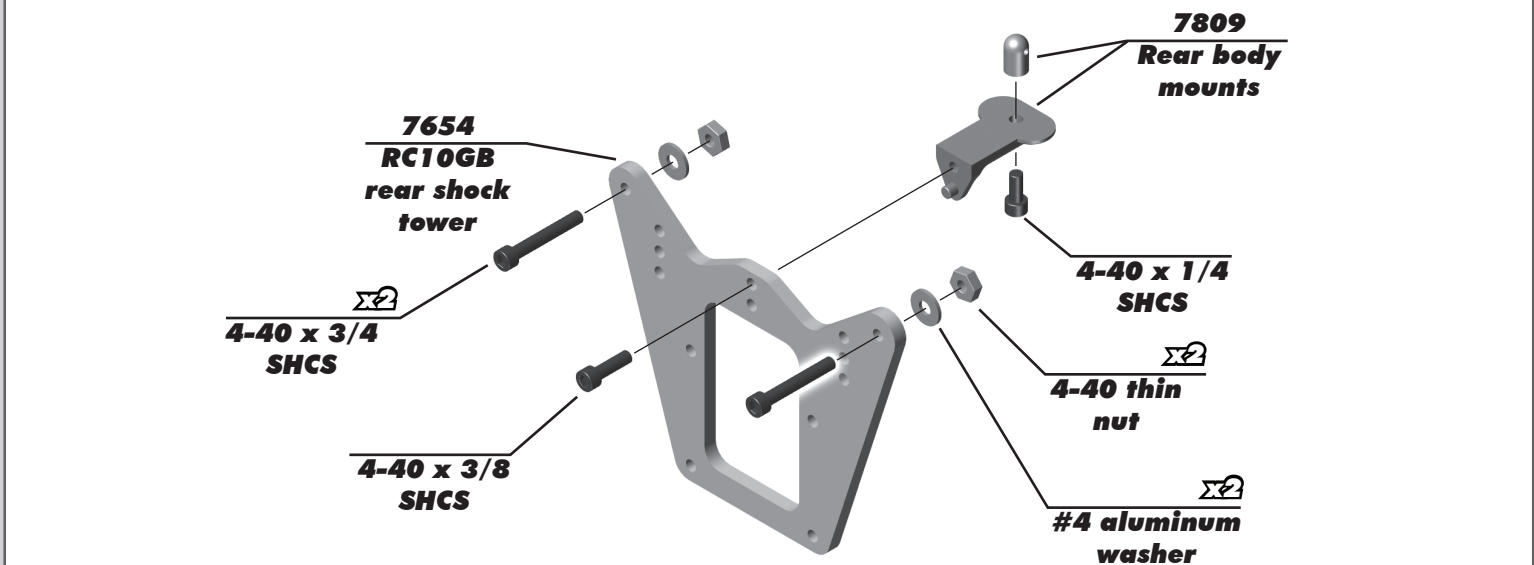

:: Rear End Build - Bag D - Step 6

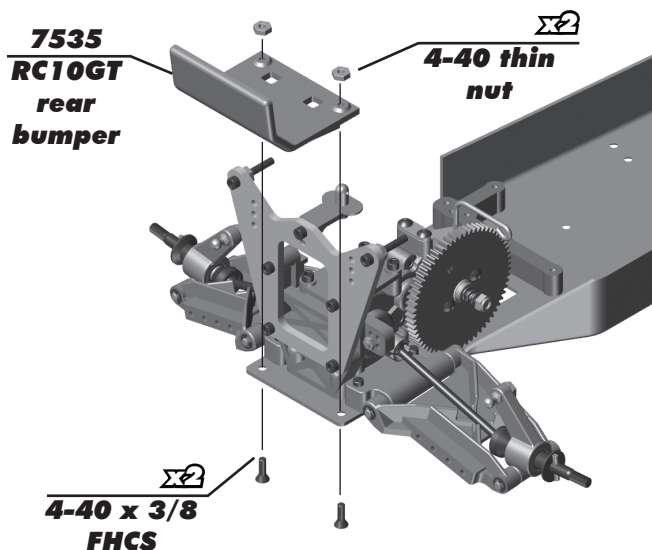
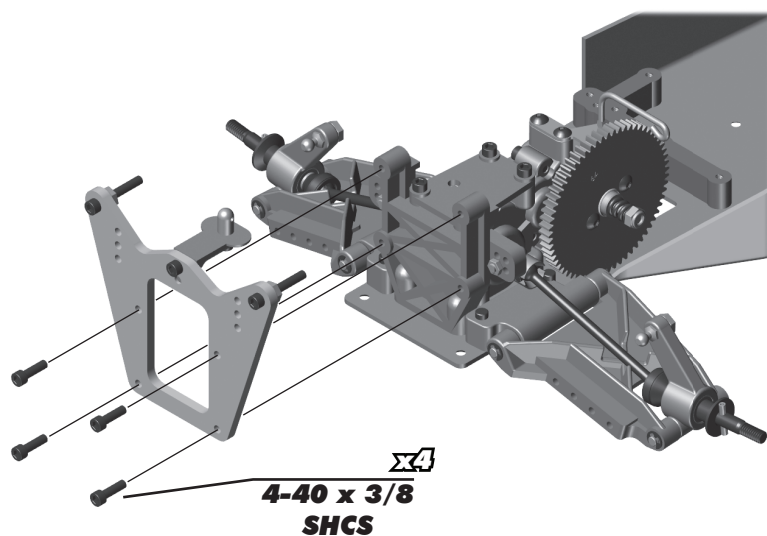

:: Shocks Build - Bag E - Step 1

**Remove
spurs**

Piston

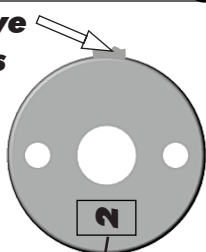

Piston number here
Use #3 = front shocks
Use #2 = rear shocks



TIP: Use marker
to mark the piston
numbers for easy
identification!

6299
E-clip
(small)

6460
Shock shaft,
front (0.71)

6417
Shock shaft,
rear (1.02)

**Shock
pistons
(1, 2, 3)**

6299
E-clip
(small)

Build two front and two rear!

:: Shocks Build - Bag E - Step 2

5407 x2
Red o-ring

6421 **x2**
Off-road shock
internals

6437
Shock body,
front (0.71)
Hard Anodized
(FT part)

**Front
Shock**

6435
Shock body,
rear (1.32)
Hard Anodized
Steering or
front camber?

**Rear
Shock**



Place on table
and push down
hard until clamp
snaps into place

**Remove
spurs**

**Shock
assembly
tool**

SNAP!

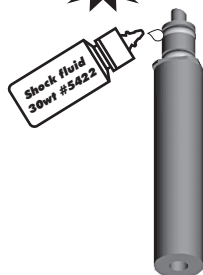

SNAP!

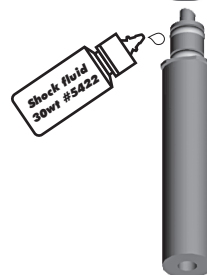

:: Shocks Build - Bag E - Step 3

Front Shock



Rear Shock

6421 Shock downstops

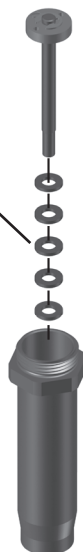

6421 Shock cap o-ring

6421 Shock pivot ball

6421 Shock rod end

Build two front and two rear!

:: Shocks Build - Bag E - Step 4

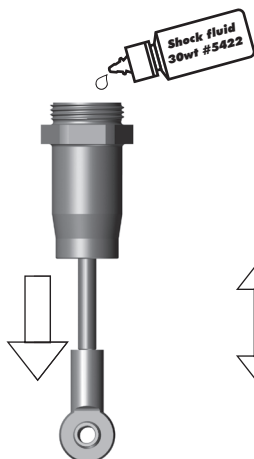

Step 1-3

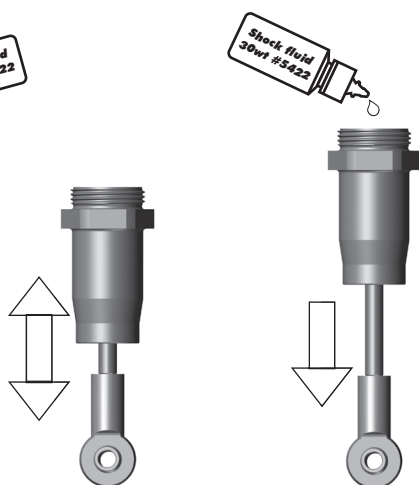

Step 3-4

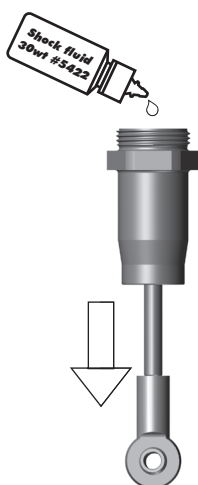

Step 5-6

6421 RC10 shock cap Gold



Step 7

* Shock Bleeding Steps:

1. Pull shock shaft down.
2. Fill shock body 3/4 full with silicone fluid.
3. Slowly move the shock shaft up and down to remove air from under piston.
4. Wait for bubbles to come to surface.
5. Fill shock body to top with silicone fluid.
6. Place several drops of oil in the cap and on cap threads.
7. Install cap and tighten completely.
8. Slowly compress shaft all the way to the top. If there is pressure at the top of the stroke, there is too much oil. You must bleed it out.
9. Slowly pull shaft down.
10. Unscrew the cap 3/4 turn and tilt the shock at a slight angle.
11. Slowly compress the shaft to push out excess oil and air. You should see bubbles coming out from under the cap.
12. With the shaft compressed, tighten the cap and re-check for pressure at the top of the stroke. If there is still pressure, repeat steps 9 thru 11.

:: Shocks Build - Bag E - Step 5

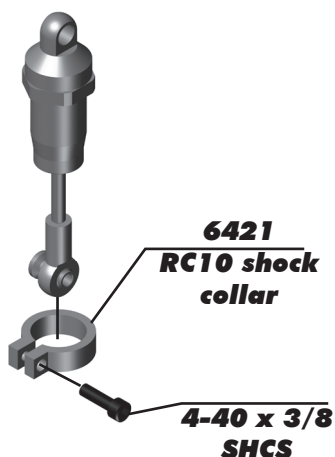

6421 RC10 shock collar

4-40 x 3/8 SHCS

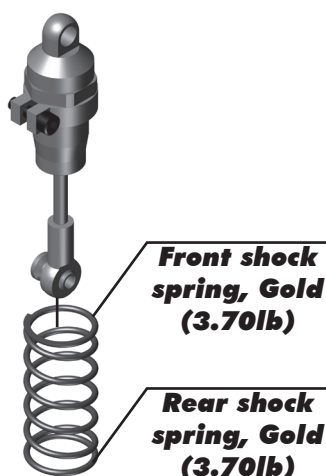

Front shock spring, Gold (3.70lb)

Rear shock spring, Gold (3.70lb)

*Ride height setting may change due to varying weight of batteries and electronics

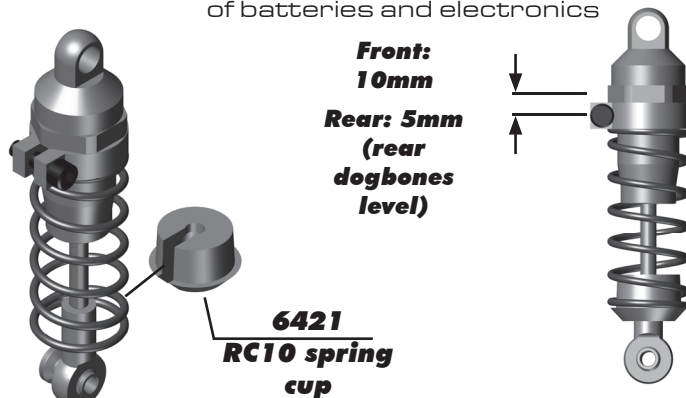

6421 RC10 spring cup

**Front: 10mm
Rear: 5mm (rear dogbones level)**

Build two front and two rear!

:: Shocks Build - Bag E - Step 6

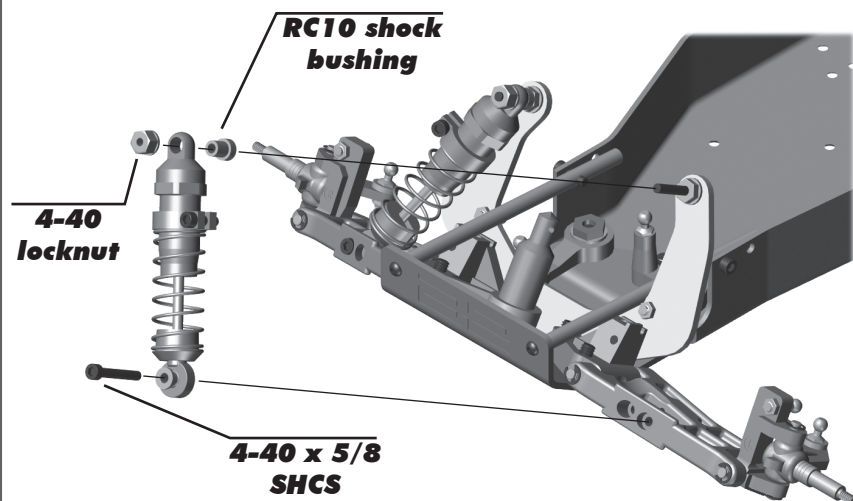

Build left and right sides!



:: Shocks Build - Bag E - Step 7

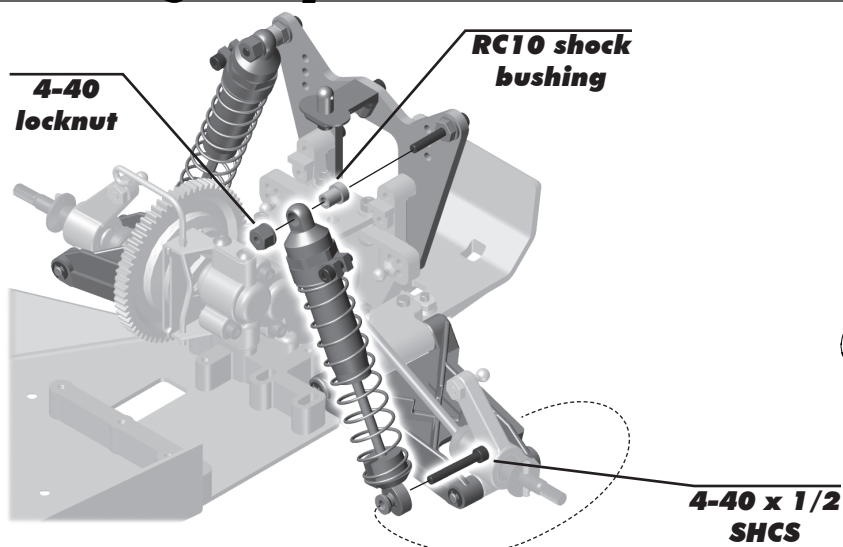

Build left and right sides!

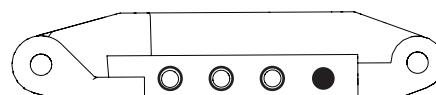

Build left and right sides!

:: Turnbuckles Build - Bag F - Step 1

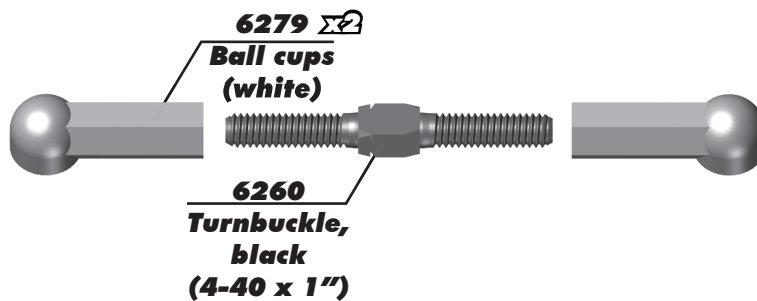
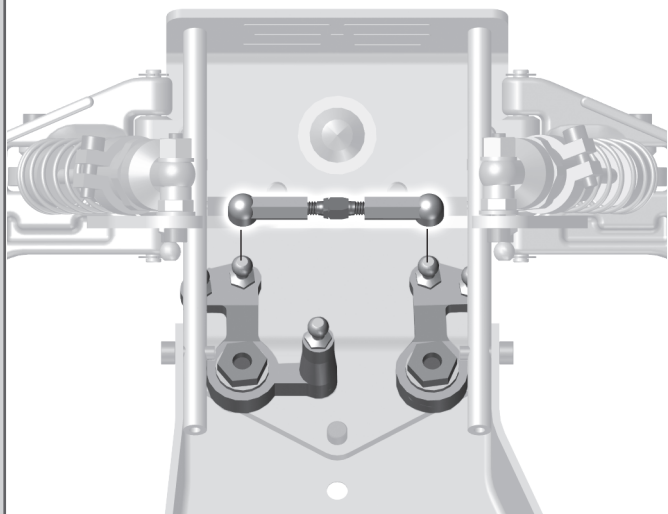

**Bellcrank Turnbuckle
0.39" (10.0mm)**

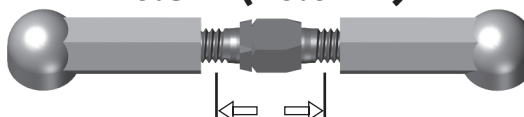

:: Turnbuckles Build - Bag F - Step 2

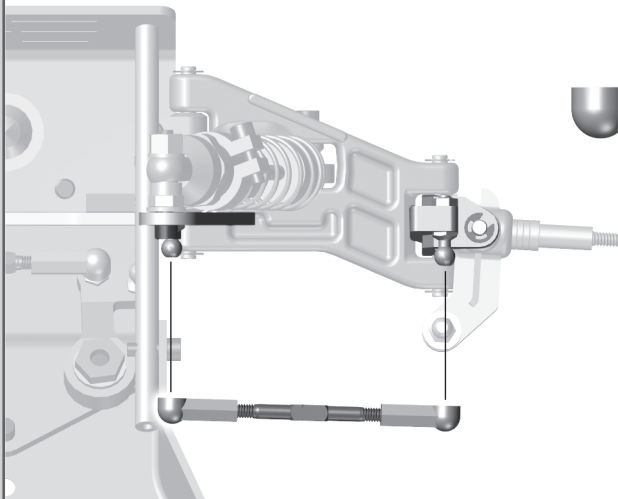

Build left and right sides!

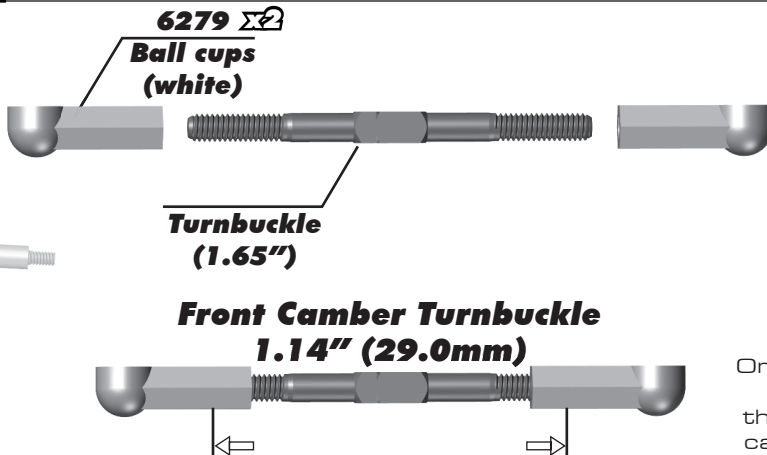

Recommended turnbuckle lengths are approximate. Final recommended settings = 0 degree Front Toe in and -2 Degree Camber Front and Rear.

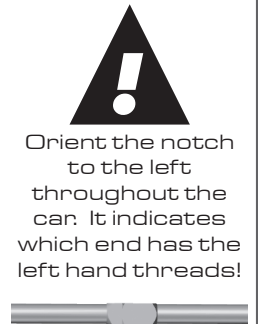

:: Turnbuckles Build - Bag F - Step 3

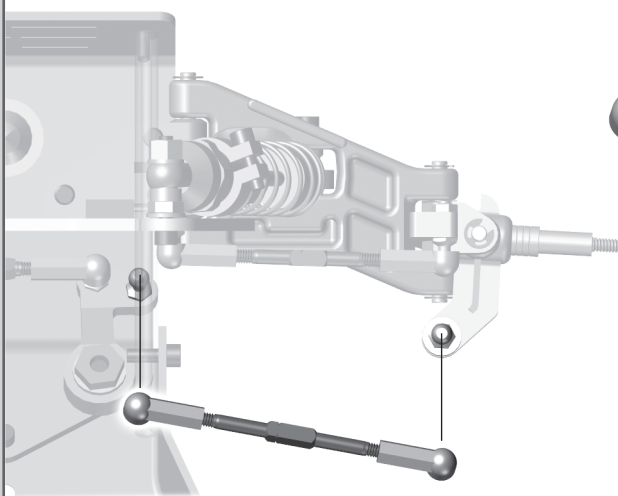

Build left and right sides!

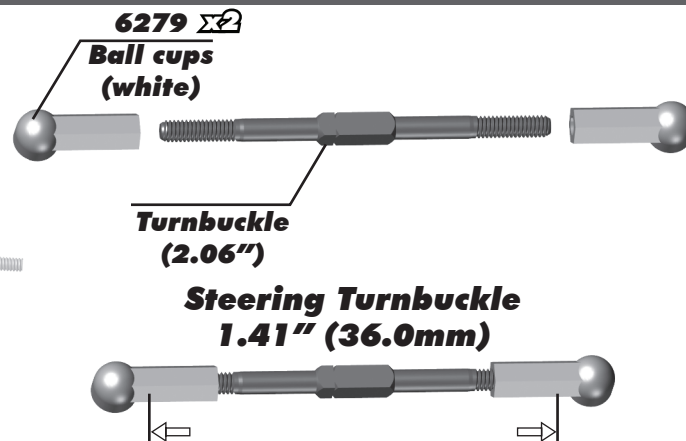

Recommended turnbuckle lengths are approximate. Final recommended settings = 0 degree Front Toe in and -2 Degree Camber Front and Rear.

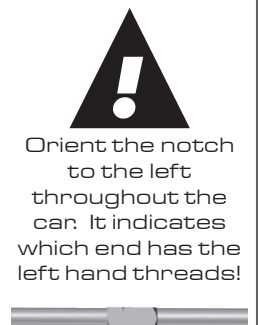

:: Turnbuckles Build - Bag F - Step 4

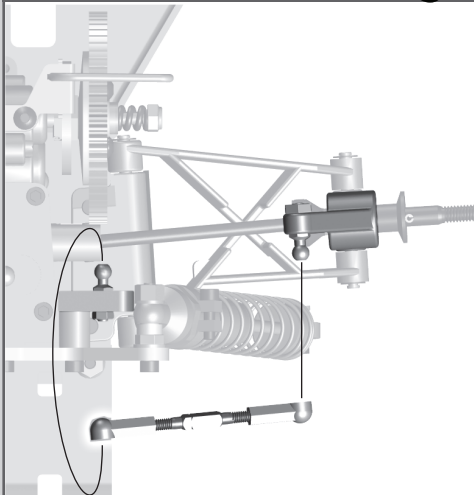

Build left and right sides!

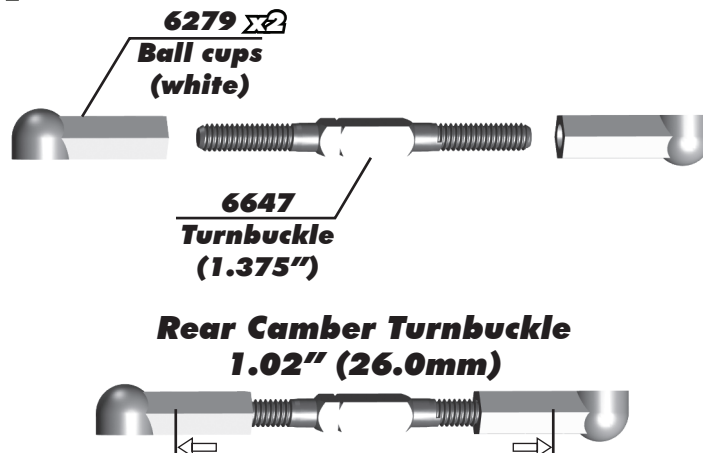

Recommended turnbuckle lengths are approximate. Final recommended settings = 0 degree Front Toe in and -2 Degree Camber Front and Rear.



:: Wheel and Tire Build - Bag G - Step 1

6756
RC10 ribbed
front tire,
2.2"



6852
RC10 one-piece
front wheels,
1/8", white

Build 2

6545
RC10 spike
rear tire

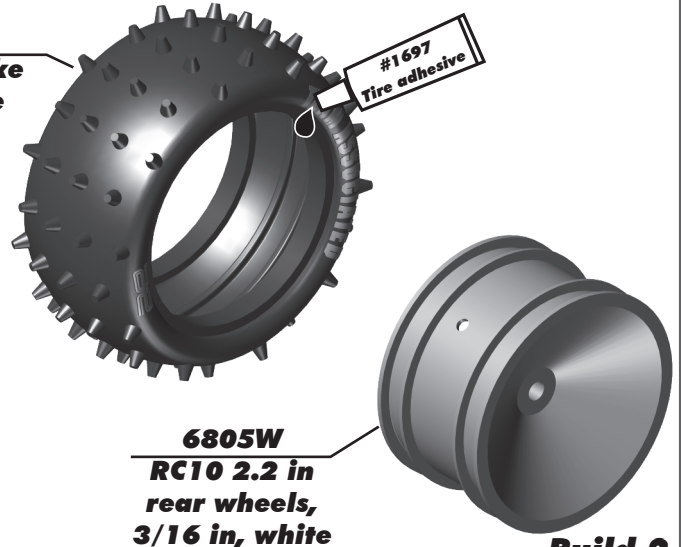

6805W
RC10 2.2 in
rear wheels,
3/16 in, white

Build 2

:: Wheel and Tire Build - Bag G - Step 2

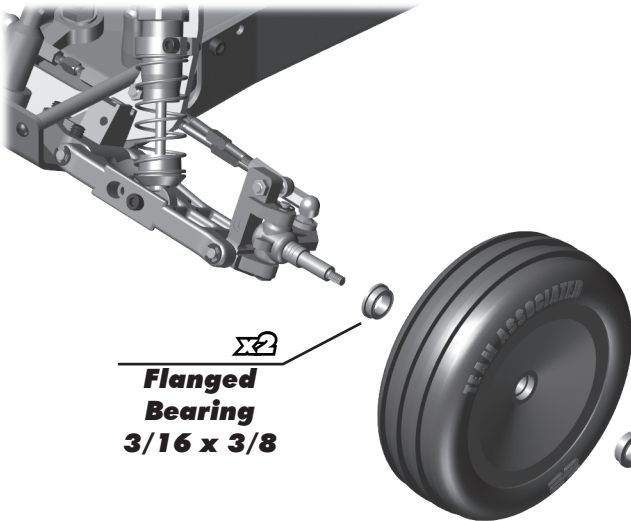

**Flanged
Bearing**
3/16 x 3/8

Build left and right sides!

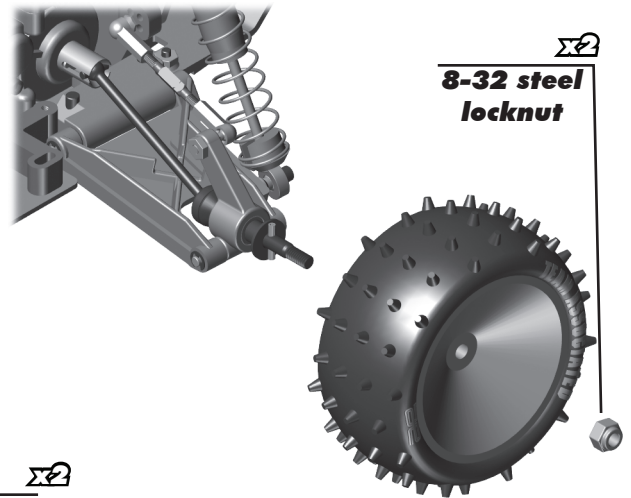

**8-32 steel
locknut**

**5-40
locknut**

Build left and right sides!

:: Fuel Tank / Servo Build - Bag F / H - Step 1

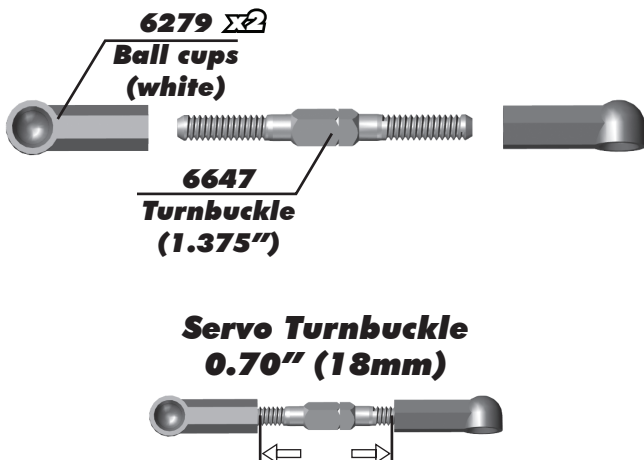

6279 $\Sigma 2$
Ball cups
(white)

6647
Turnbuckle
(1.375")

Servo Turnbuckle
0.70" (18mm)

7534 $\Sigma 2$
Steering
servo mounts

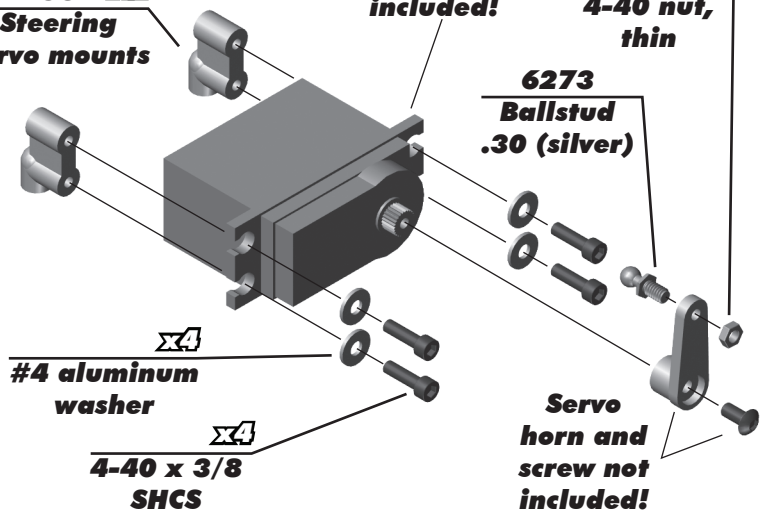

**Servo not
included!**

**4-40 nut,
thin**

6273
Ballstud
.30 (silver)

**#4 aluminum
washer**

**4-40 x 3/8
SHCS**

**Servo
horn and
screw not
included!**

:: Fuel Tank / Servo Build - Bag F / H - Step 2

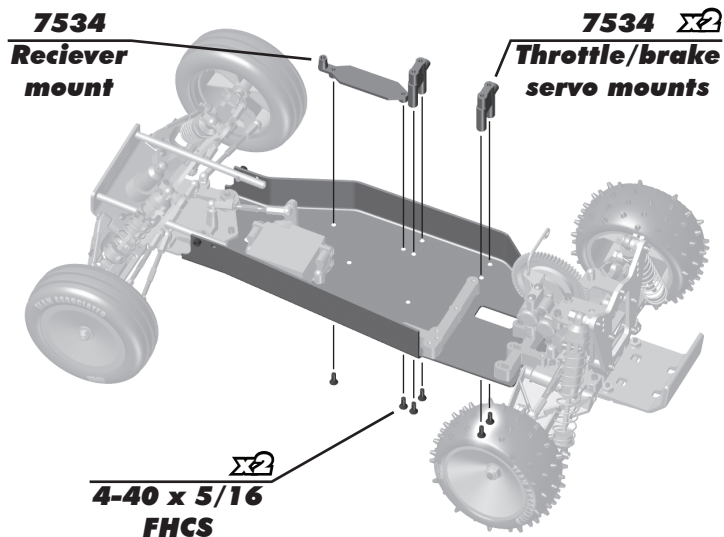
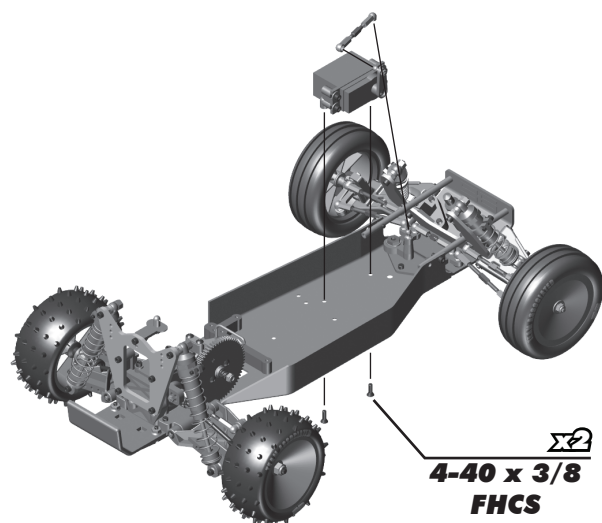

:: Fuel Tank / Servo Build - Bag H - Step 3

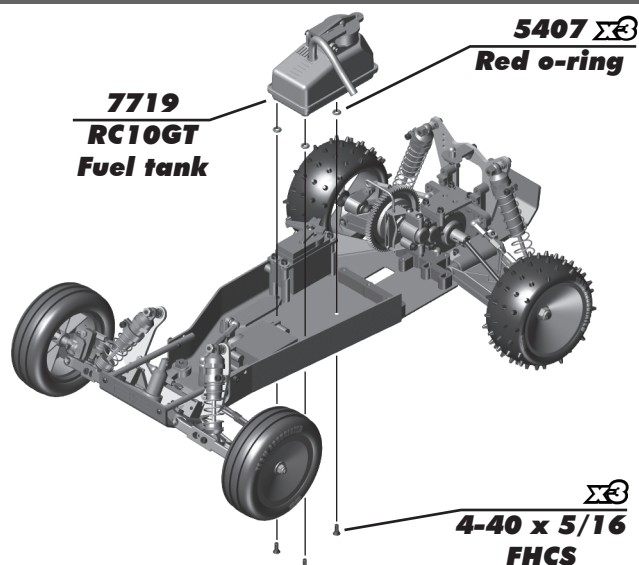
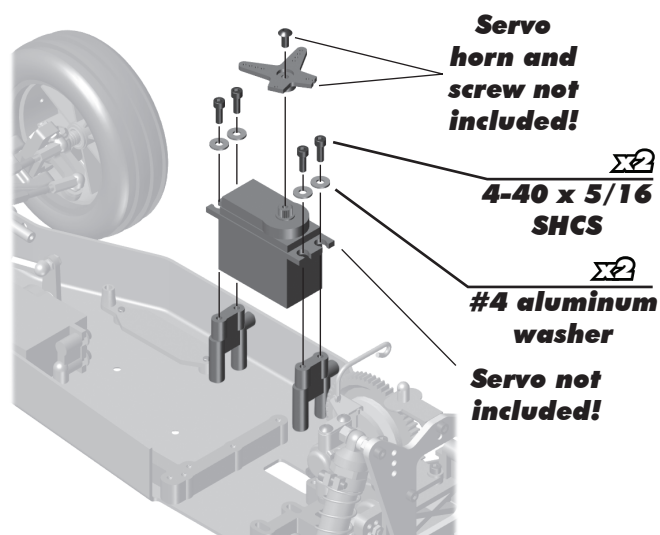

:: Engine / Exhaust Install - Bag I - Step 1

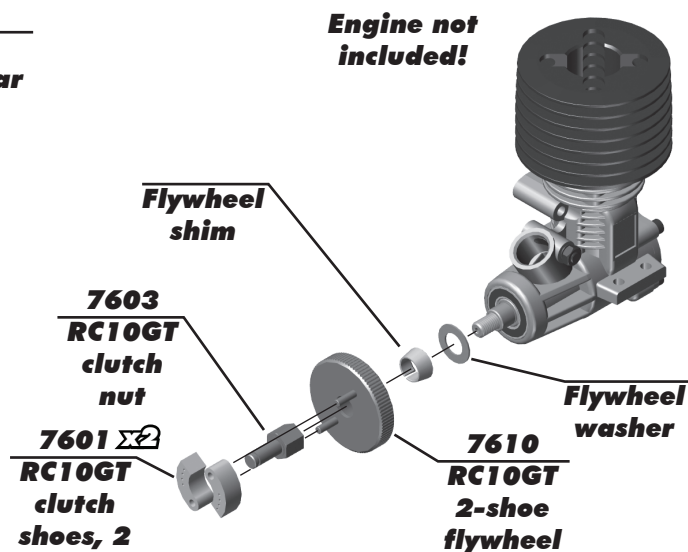
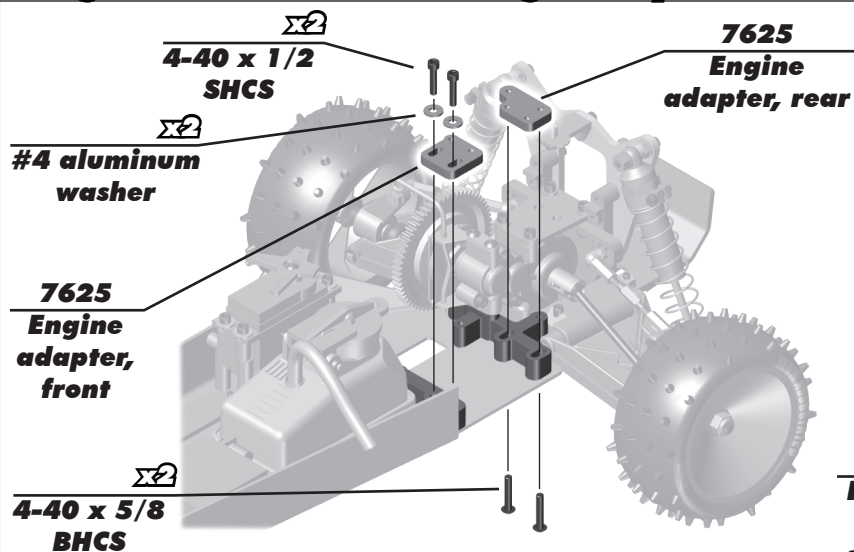

:: Engine / Exhaust Install - Bag I - Step 2

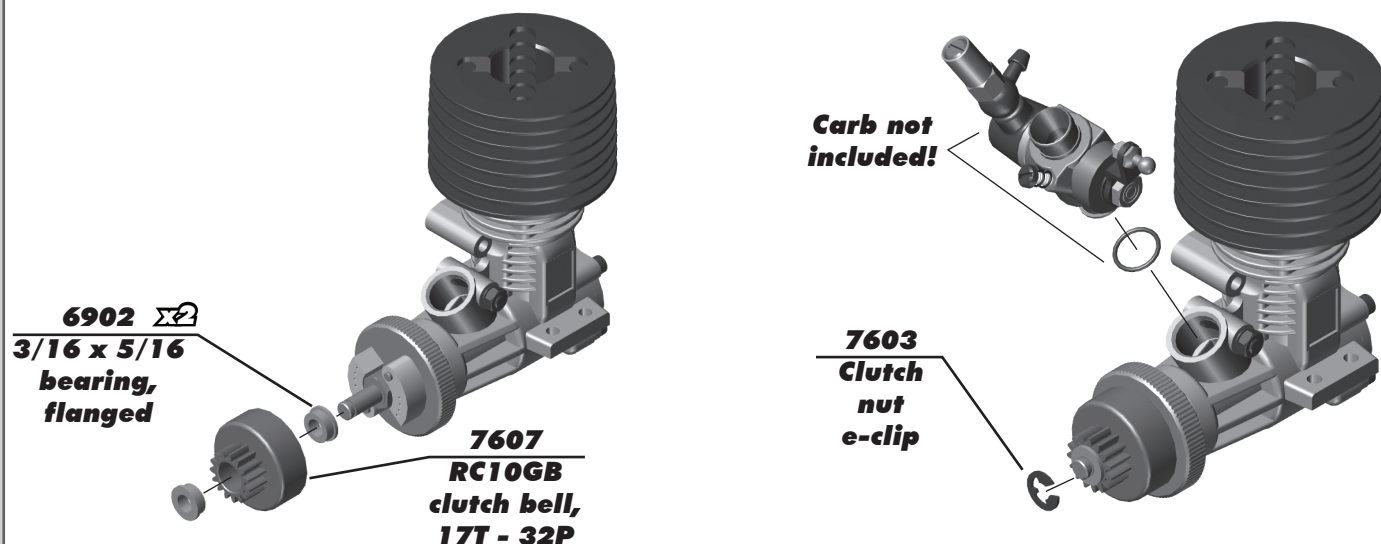

:: Engine / Exhaust Install - Bag I - Step 3

Engine Installation.

Line up your engine with the clutch assembly and flywheel assembly in your engine mount. Center your engine on your mount. Now fasten the motor to the mount with four screws. Do not tighten yet!

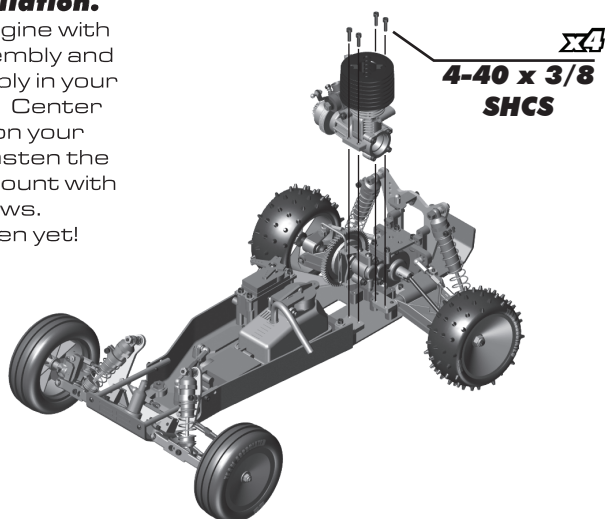

Check gear mesh.

Set the gear-to-pinion gear spacing (gear mesh). Make sure you can still slide your engine mount, then mesh the clutch bell pinion with the spur gear. The correct gear spacing is when the pinion is as close to the spur gear as possible, but if you hold the pinion gear, you should still be able to rock the spur gear back and forth slightly with light pressure. Roll the gears and check the mesh in several different locations on the spur gear teeth to check if the spur gear is slightly out of round.



:: Engine / Exhaust Install - Bag I - Step 4

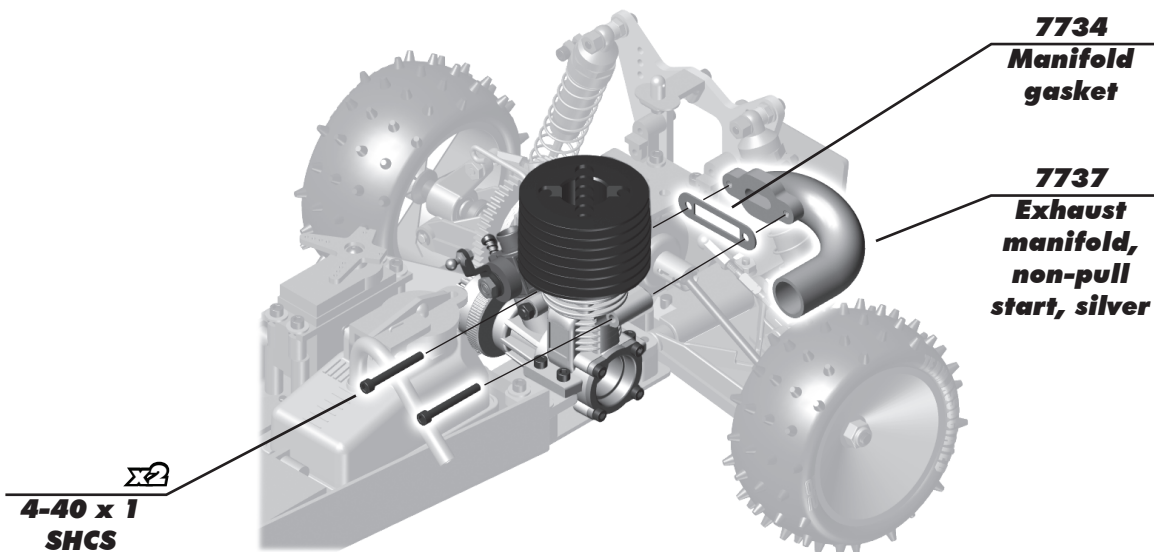

:: Engine / Exhaust Install - Bag I - Step 4

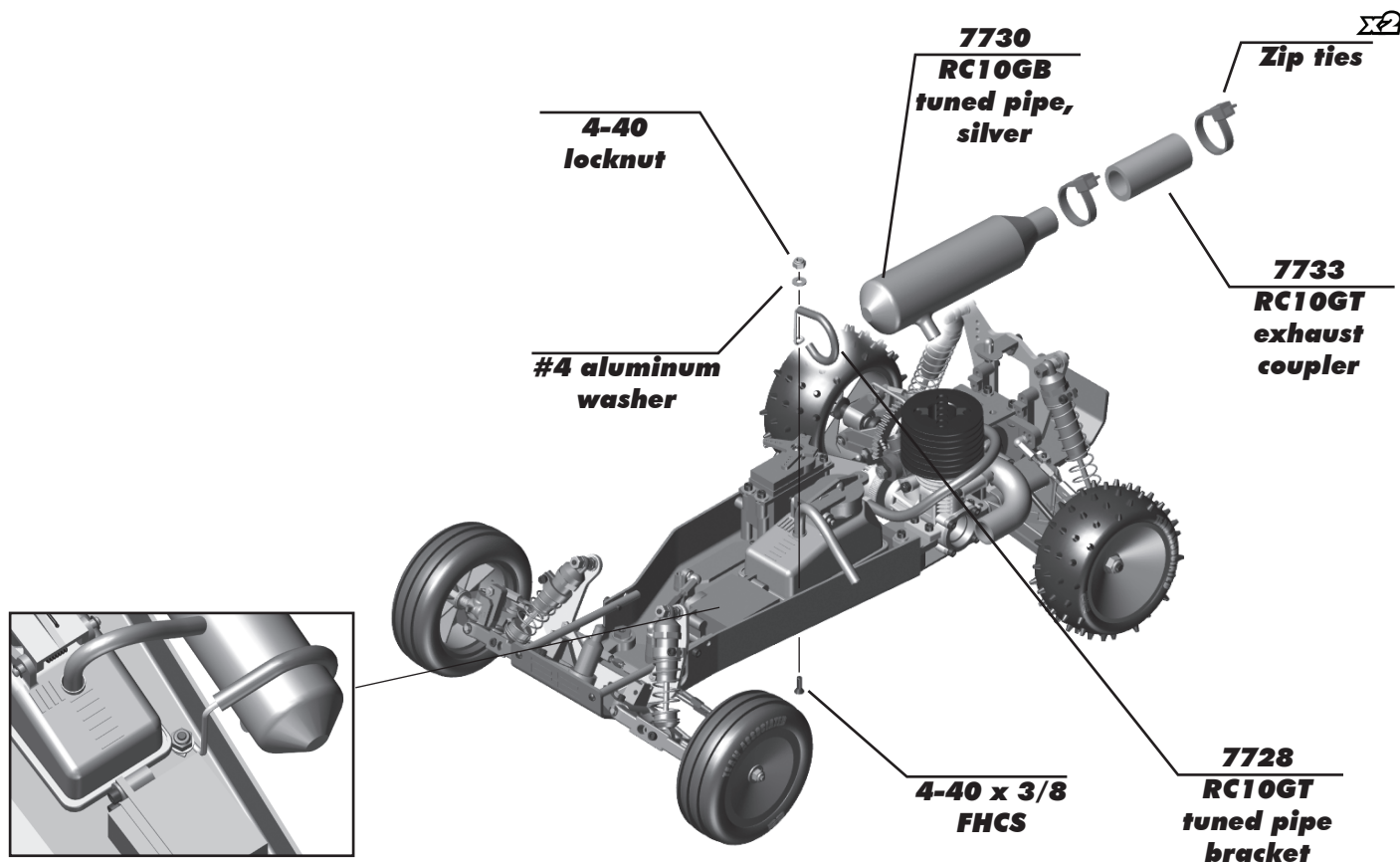

:: Throttle and Brake Links - Bag J - Step 1

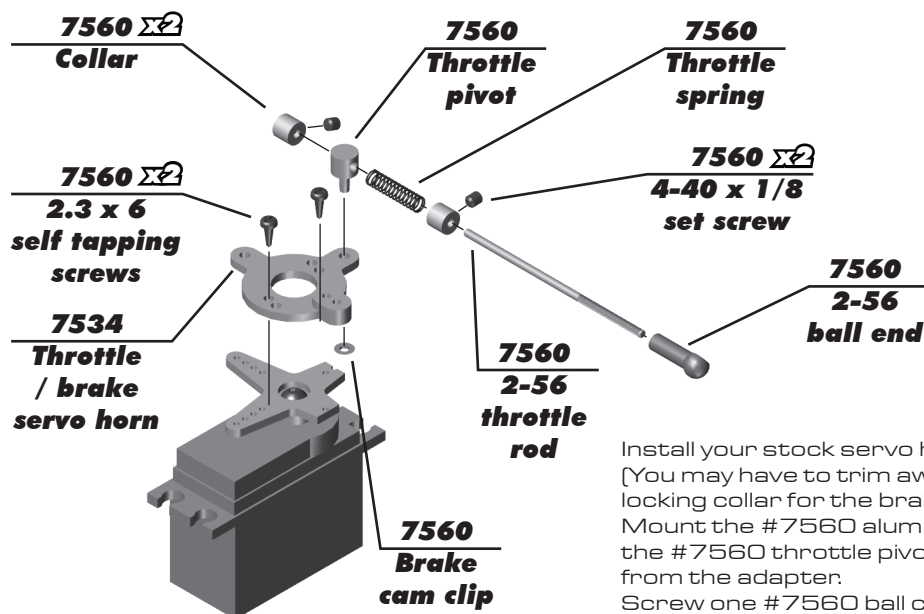

Install your stock servo horn to your servo with the stock servo screw. [You may have to trim away a part of your stock servo horn so the locking collar for the brake linkage in Step 9 won't hit it.]

Mount the #7560 aluminum throttle pivot to the #7534 adapter with the #7560 throttle pivot clip, with the clip's inner teeth flaring away from the adapter.

Screw one #7560 ball cup onto the end of the #7560 throttle rod. Slide on one #7560 collar about an inch away from the ball cup and tighten it down with a #7560 set screw.

Slide on the #7560 long throttle spring. Slide the throttle rod through the throttle pivot, then slide on and fasten the second #7560 collar to the rod so there is about one inch [xxmm] of space between collars.

Attach the servo horn adapter assembly to your servo horn with the two #7560 screws provided. See photo for proper orientation of adapter to your servo.

Snap the ball cup onto the carb's ball end.

Cut off the remaining part of the throttle rod. Make sure you leave 1/2 inch [12.7mm] so you can adjust the throttle linkage.

:: Throttle and Brake Links - Bag J - Step 2

BRAKE LINKAGE

- 1) Add a #7560 collar onto the second rod and secure it about 3/8" [9.53mm] from the end of the threads. See drawing below.
- 2) Bend the brake rod according to the actual size drawing below, including the angled bend at the short side. Cut the rod to the length shown.
- 3) Slide the threaded end of the rod through the disc brake cam. Drop the bent end of the brake rod through the adapter hole shown. Attach a #7560 collar with a #6951 set screw to the end of the rod.
- 4) Slide on another 7560 collar with #6951 set screw, a #7560 washer, then the #4118 spring, then the #7560 locknut.
- 5) Tighten the locknut down until shown in the picture.

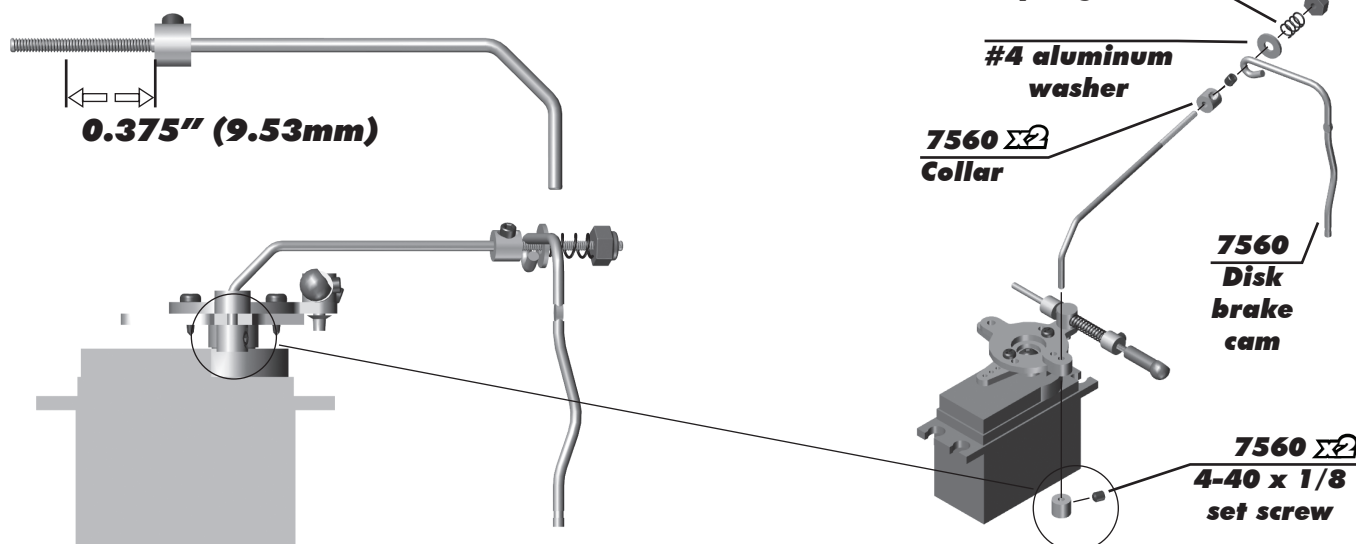

:: Throttle and Brake Links - Bag J - Step 3

IDLE SETTING

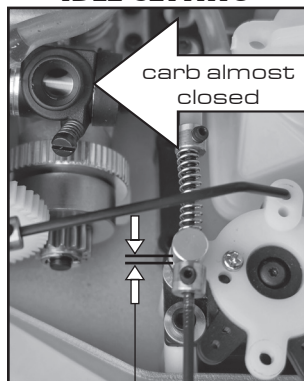

1) Small gap here

Adjust the throttle linkage

1) Turn on your transmitter then the kit's electronics (don't start the engine). When at idle (trigger of transmitter not pulled), adjust the collar near the adapter so there is up to 1/16" [1.58 mm] of space between the collar and pivot.

FULL THROTTLE

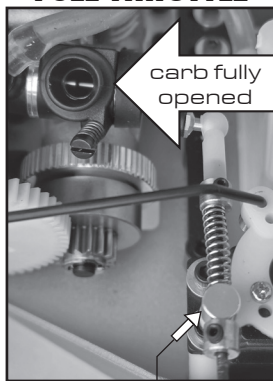

2)

2) Apply full throttle (pull the trigger of your transmitter all the way back). Your carb should be fully open. If it is not, then adjust the collar nearest to the adapter. [You may also adjust your throttle trim according to your radio's instructions.]

3) Now apply the brake. Your carb should be at idle position. The spring should not be completely compressed.

BRAKE APPLIED

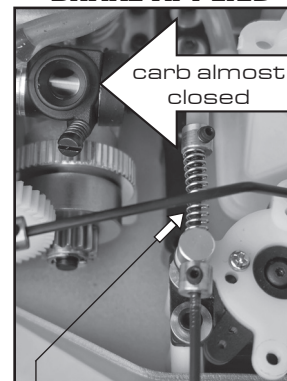

3) Should not be fully compressed

4) IDLE SETTING

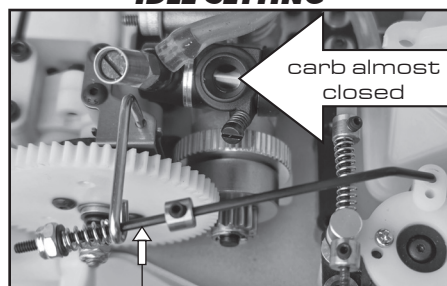

4) Small gap here

5) FULL THROTTLE

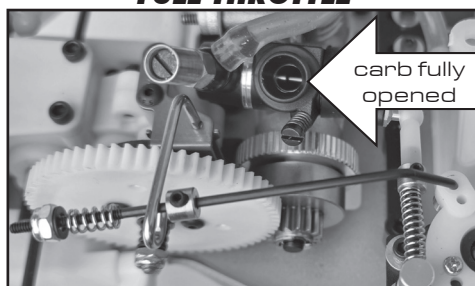

6) BRAKE APPLIED

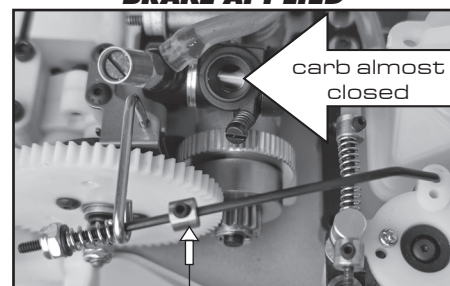

6)

:: Fuel Tubing Install - Bag Misc. - Step 1

FUEL TUBING

Slide one end of the #7724 fuel tubing onto the fuel tank outlet fitting. Bring the other end of the tubing over to the other fitting. When you have the correct length without kinks in the tubing or rubbing against other parts of the truck, then mark the fuel tubing and cut it to that length. Again check to make sure the fuel line clears the spur gear or any other parts.

Install the tubing into the fitting on the top of the fuel tank. Take one of the small wire ties and loop it around the muffler bracket, leaving as large a loop in it as possible. Take your fuel tubing and run it through the wire tie, then loop it around and bring it back through the same side of the wire tie again. Now take the end of the tubing and squeeze it into the hole in the tuned pipe muffler about 3/8". Now tighten the wire tie, but not so tight that it will begin to compress the tubing. Cut off the end of the wire tie.

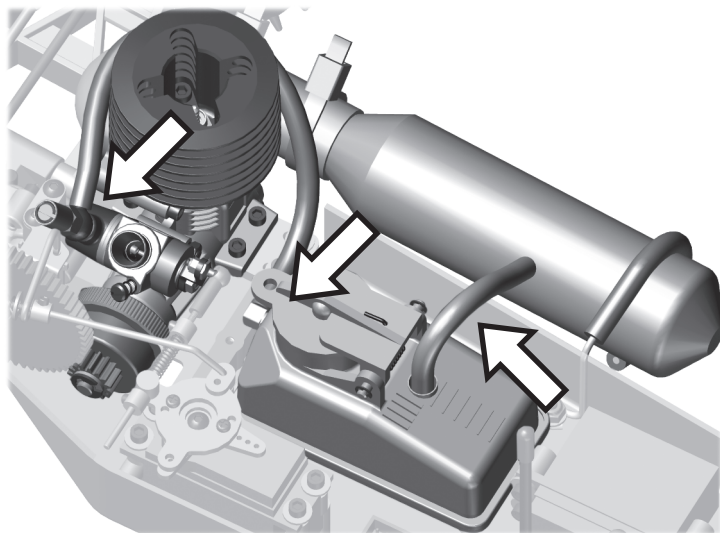



:: Air Filter Install - Bag Misc. - Step 1

7542 

Air filter
foam

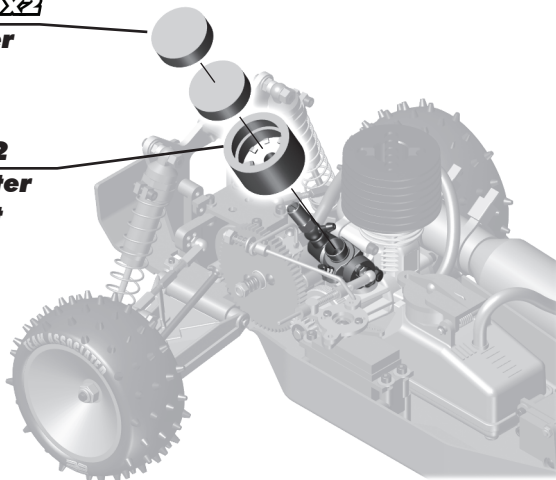
7542
Air filter
boot



 Pre-lube the air filter
outer elements

Zip tie the air filter boot to the carb.

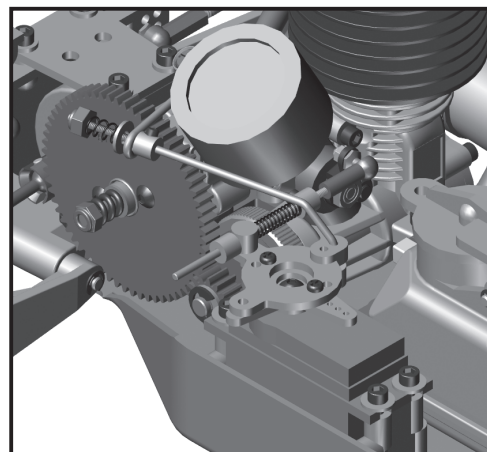

:: Receiver Battery Pack - Bag D, I, Misc. - Step 1

7535
Foam pad

x2
Zip ties

**Receiver
battery not
included!**

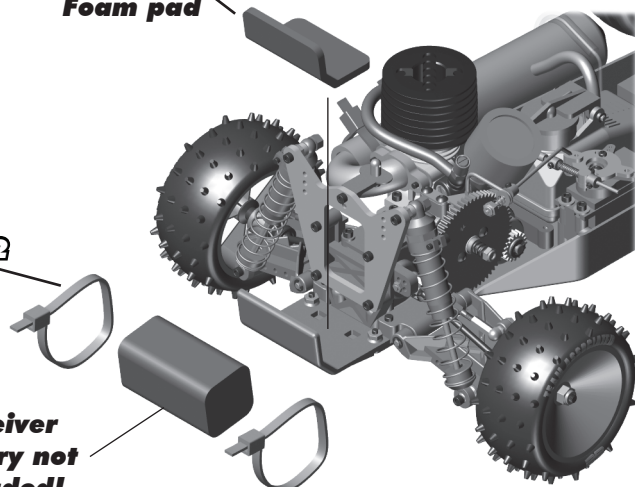

**Run zip ties thru the
openings of the rear bumper
and around the receiver
battery pack as shown.**

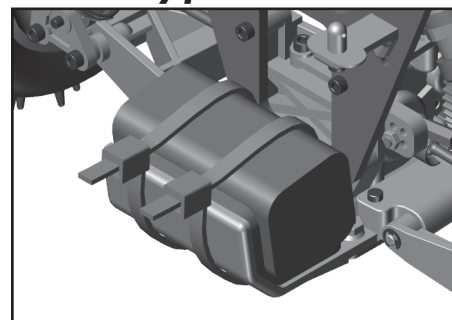

:: Antenna, Receiver, Body Install - Bag K, Misc. - Step 1

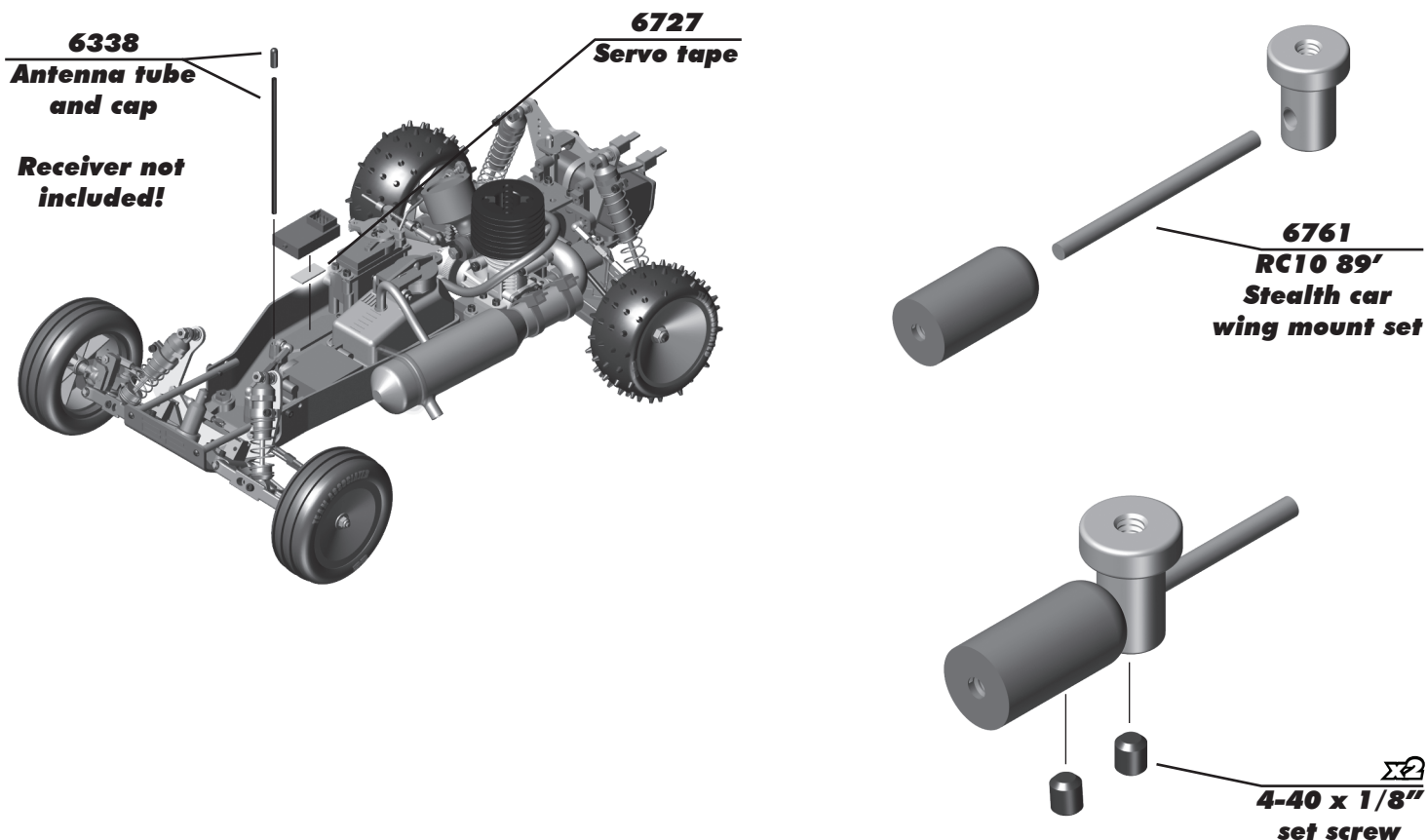

:: Antenna, Receiver, Body Install - Bag K, Misc. - Step 2

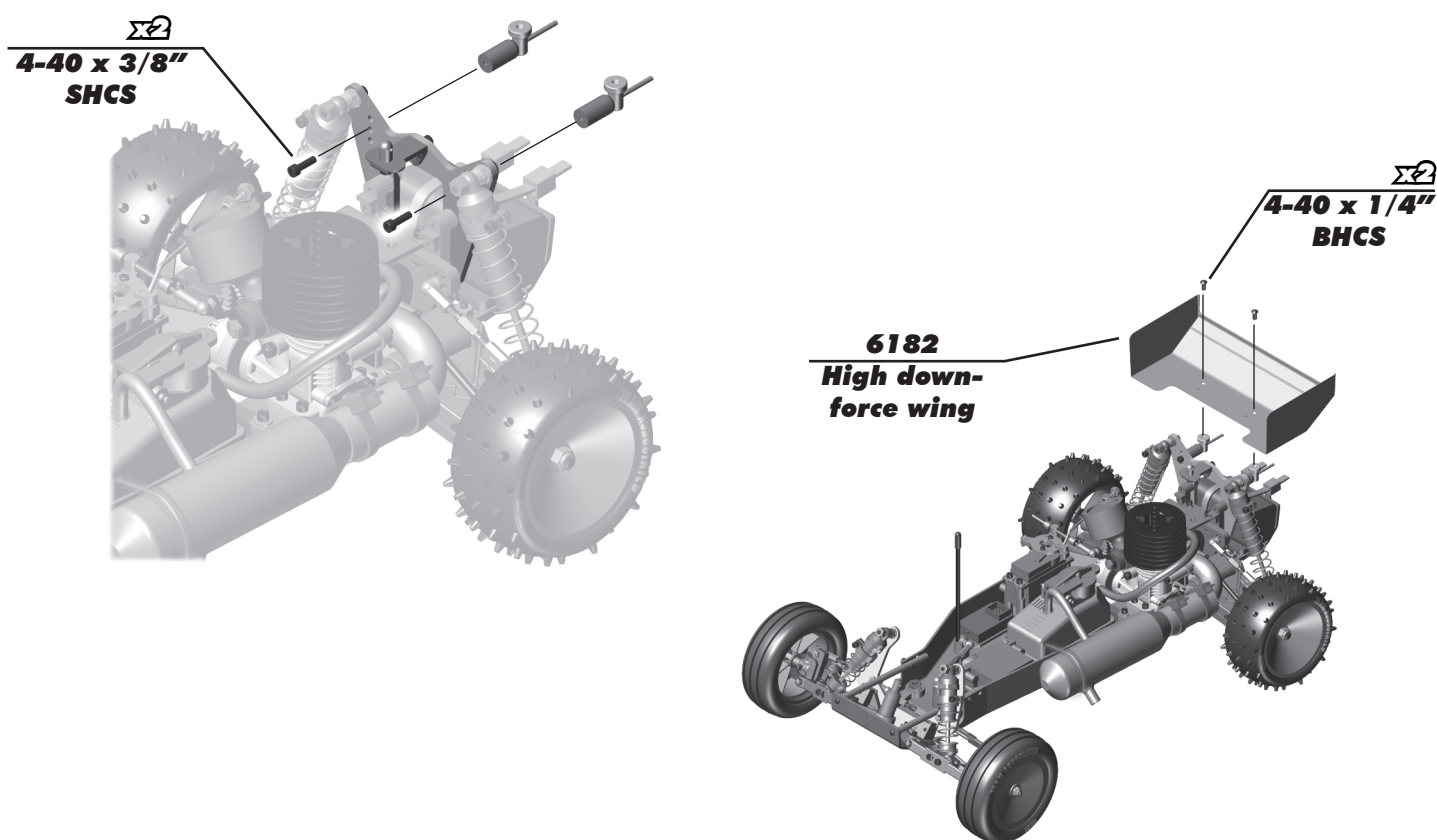

FIND IT ON ASSOCIATEDELECTRICS.COM

CARS & TRUCKS



Vehicle Spare Parts

GO TO:

AssociatedElectrics.com →
Team Associated tab →
Cars & Trucks →
Scroll to your vehicle →
Parts & Accessories link

**SETUP SHEETS
& MANUALS**



Setups and Manuals

GO TO:

AssociatedElectrics.com →
Team Associated tab →
Manuals & Setups →
Scroll to your vehicle

A-TEAM APPS



Tuning Guides & Tips

GO TO:

AssociatedElectrics.com →
Support →
A-Team Apps



Associated Electrics, Inc.

21062 Bake Parkway Lake Forest, CA 92630 USA

call: (949) 544-7500 - fax: (949) 544-7501

**Check out the following web sites for all of our kits, current products,
new releases, setup help, tips, and racing info!**

www.AssociatedElectrics.com

FOLLOW US ON SOCIAL MEDIA



TeamAssociated
ReedyPower
ElementRC
Factory Team

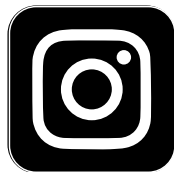

@TeamAssociatedRC
@ReedyPower
@Element_RC
@FactoryTeam_RC



@Team_Associated
@ReedyPower

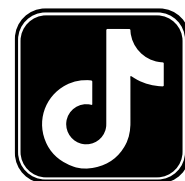

@Associated_Electrics